

DEPARTMENT OF MINES AND ENERGY
SOUTH AUSTRALIA

Rept. Bk. No. 80/5

A SOURCE-BOOK FOR THE OFFICER BASIN
AREA IN SOUTH AUSTRALIA

Report No. 3 of the OFFICER BASIN
STUDY GROUP

By

G.M. PITT

and

BRIDGET C. YOUNGS

February, 1980

D.M. No. 653/78

<u>CONTENTS</u>	<u>PAGE</u>
ABSTRACT	1
INTRODUCTION	1
SUBJECT INDEX	4
LIST OF PRINCIPAL REFERENCES	10
BIBLIOGRAPHY	14
COMPILATION PLANS	45

FIGURES

<u>Figure</u>	<u>Title</u>	<u>Drg. No.</u>
1	Locality plan, Officer Basin area	S14477
2	Regional geological maps, 1:250 000 scale.	S14498
3	Explanatory notes for 1:250 000 scale Atlas Series geological maps.	S14499
4	Regional aeromagnetic surveys, composite maps prepared, 1:250 000 scale.	S14500
5	Regional gravity surveys, 1:250 000 scale map compilations.	S14501
6	Seismic shotpoint location maps, 1:250 000 scale.	S14502
7	Metallic Exploration Index Series maps, 1:50 000 and 1:500 000 scale.	S14503
8	Borehole location maps, 1:250 000 scale.	S14504
9	Areas covered by geophysical surveys.	79-862

DEPARTMENT OF MINES AND ENERGY
SOUTH AUSTRALIA

Rept. Bk. No. 80/5
D.M. No. 653/78

A SOURCE-BOOK FOR THE OFFICER BASIN AREA
IN
SOUTH AUSTRALIA

ABSTRACT

This report compiles approximately two hundred references to the Officer Basin area of South Australia. They include studies of the petroleum potential, geology, geophysics and palaeontology of the Proterozoic-Palaeozoic Officer Basin as well as the post-Palaeozoic geology of the area and related topics such as regional tectonics. Selected references are included on other topics such as the early exploration of the area and the geology of the Western Australian part of the Officer Basin and the Amadeus Basin in the Northern Territory. In view of the occurrence of both chert and evaporites in the Observatory Hill Beds, some references are included on the geology of this association.

The references are keyword-indexed to facilitate retrieval. A list of principal references, and key-maps to compilation plans available from this Department, are provided.

INTRODUCTION

This source-book is a bibliographic compilation of geological and geophysical work in the Officer Basin area of South Australia, and in addition covers other areas and aspects of geology considered relevant to the Officer Basin.

A "Subject Index" (p. 4) offers a guide to all of the references : the numbers refer to the sequential order of references in the "Bibliography" (p. 14).

The "List of Principal References" (p. 10) presents 26 major references that deal most directly with the geology and geophysics of the Officer Basin in South Australia. These selected references are repeated in the complete "Bibliography".

Entries in the "List of Principal References" and the "Bibliography" have been given sequential numbers (in brackets)

and code numbers (below the sequential number). The code numbers relate to the major topics covered in each reference:

<u>Code Number</u>	<u>Topic</u>
1	Officer Basin, South Australia: petroleum potential.
2	Officer Basin, South Australia: regional geology, stratigraphy, drilling.
3	Officer Basin, South Australia: geophysics and geophysical exploration for petroleum.
4	Officer Basin, South Australia: biostratigraphic studies.
5	Officer Basin area, South Australia: post-Palaeozoic geology.
6	Officer Basin area, Western Australia, and Amadeus Basin, Northern Territory: selected references.
7	Officer Basin area, South Australia: early exploration and geological references of some historical interest.
8	Related topics and selected references including regional tectonics.
9	The geology of the evaporite/chert association: selected references.

An example of one reference is presented below:

(184)

2, 5, 8 Thomson, B.P. (Compiler), 1979. Geological Map of South Australia, 1:1 000 000 scale. Geol. Surv. S. Aust. (in press).

This reference is number 184 in the sequential order and the major topics covered by it are those listed above against code numbers 2, 5 and 8.

Almost one half of the present bibliography is contained in the SADME computer-based Bibliography Index, and such references (primarily company and SADME reports) may be selectively retrieved

using that system. All SAMDE geological and geophysical Report Books and Envelopes referenced here are on Open File, and are available from this department upon request.

A bibliography rarely succeeds in being exhaustive: we would therefore welcome advice on omissions, corrections or future additions.

SUBJECT INDEX

Acritarchs: 53, 137

Aeromagnetic Survey: 41, 42, 133, 138, 139, 159, 173

ALBERGA 1:250 000: 20

Amadeus Basin: 30, 206

Ammaroodina Inlier: 92

Arckaringa Basin Area: 1, 32, 62, 73, 108, 125, 126, 127,
128, 129, 132, 135, 187, 188, 190, 192,
193, 196, 217

BARTON 1:250 000: 48

Biconulites: 51

BIRKSGATE 1:250 000: 109, 110

Birksgate No. 1: 3, 21, 65, 71, 98, 99, 100, 122, 123, 170, 197

Boongar Beds: 116

Boorthanna Formation: 4, 5, 108, 186, 192, 193

Boorthanna No. 1: 73

Byilkaora No. 1: 12, 122, 123, 155, 202, 209

Cainozoic: 2, 4, 5, 6, 22, 53, 78, 85, 90, 93, 95, 101, 114, 115,
152, 153, 154, 165, 177, 208, 210, 214

Cambrian: 12, 51, 52, 53, 57, 71, 74, 89, 93, 96, 101, 102, 103,
112, 122, 123, 124, 137, 155, 156, 167, 182, 187, 188,
191, 192, 198, 202, 209, 215, 219, 220

Carbonates: 1, 12, 32, 52, 53, 57, 73, 74, 114, 135, 170, 187,
188, 191, 192, 207, 209, 212, 215, 219, 220

Chert: 12, 36, 37, 38, 40, 52, 57, 69, 115, 176, 177, 207, 209,
215, 220

Coal/lignite: 2, 4, 15, 53, 108, 154, 208, 210

COOK 1:250 000: 48

Cook No. 1: 102, 218

COOMPANA 1:250 000: 49

Cootanoorina Beds: 1, 73, 84, 135, 150, 163, 187, 192, 193

Cootanoorina No. 1: 1, 84, 163, 188

"Davies Bore Conglomerate": 12, 15, 209, 220

Denman No. 1: 103, 148, 218

Deserts: 85, 115

Devonian: 1, 27, 66, 72, 88, 89, 93, 96, 155, 163, 187, 190, 192,
193, 217, 221

Drilling (company exploration, non-petroleum): 2, 4, 5, 195, 196,
208

Drilling (stratigraphic, wildcat): 1, 12, 27, 32, 52, 57, 77, 88,
89, 101, 102, 103, 107, 124, 155,
186, 187, 188, 190, 191, 192, 219
221

Early exploration, historical geology: 8, 11, 16, 17, 54, 75, 140, 175

Emu Field : 8

Emu No. 1: 57, 105, 107, 122, 123, 166, 215

"Emu Sandstone": 57, 71

Eucla Basin: 15, 46, 57, 60, 102, 103, 123, 131, 13], 167, 218

Evaporite Minerals: 1, 12, 36, 37, 38, 39, 40, 53, 63, 64, 73,
106, 155, 170, 176, 209, 220

EVERARD 1:250 000: 93, 149, 220

Explanatory Notes: 93, 109, 111, 152

Ferricrete: 22, 214

Fossil: 51, 157, 158

FOWLER 1:250 000: 49

Geochronology: 21, 119, 198, 199, 200, 201, 202, 203

Geophysical Interpretation: 42

Giles 1:250 000: 8

Gravity Survey: 25, 26, 60, 62, 120, 133, 134, 138, 139, 141, 145,
160

Green River Formation: 14, 38, 106, 122, 123 170, 178, 179, 180, 212

Historical geology: see Early exploration.

Hughes Nos. 1-3: 103, 148, 218

Hydrology: 8, 9

Illite crystallinity: 164

Indulkana : 50
Indulkana Shale: 199
Karari Fault: 42
Karkaro No. 1: 192
Kulyong Volcanics: 119
Lacustrine (Playa) Deposits: 12, 14, 19, 36, 37, 38, 39, 40, 64,
69, 106, 155, 170, 176, 177, 178, 179
207, 209, 212
Lambina No. 1: 186, 192
Lignite: see Coal
LINDSAY 1:250 000: 111, 118
Magnetic Basement (depth to): see Aeromagnetic Survey
Mallabie No. 1: 167
Mangatitja Limestone: 114, 165
Manya No. 1: 107, 188
Maralinga: 9, 78, 101
Marla No. 1, 1A, 1B: 107, 188, 219
MAURICE 1:250 000: 91
Mesozoic: 2, 93, 95, 101, 108, 152, 165, 177, 186, 187, 188, 190,
192, 219
Metallic Mineralization: 12, 52, 53, 107, 155, 182, 195, 196, 209, 219
Microfossils: 1, 3, 27, 28, 29, 53, 65, 66, 74, 97, 98, 99, 100,
105, 137, 194, 221
Mintabie: 72
Mt Chandler Sandstone: 116, 155, 156, 220
Mt Furner No. 1: 192
Mt Johns Conglomerate : 12, 93, 149, 155, 220
Mt Toondina Formation: 108, 192, 193
Mt Willoughby No. 1: 187, 192
Munyarai No. 1: 18, 27, 66, 107, 123, 146, 147, 164, 194, 221
MURLOOCOPPIE 1000: 152
Murnaroo No. 1: 52, 82, 107, 122, 123, 203
"Murnaroo Sandstone": 52, 57

Musgrave Block: 134

NOORINA 1:250 000 : 91

NULLARBOR 1:250 000: 49

Observatory Hill Beds (Wirrildar Beds): 12, 28, 29, 51, 52, 57, 71,
74, 112, 122, 123, 124, 135,
137, 155, 156, 188, 191,
198, 200, 202, 203, 208, 209,
215, 219, 220

Officer Basin (Western Australia): 56, 76, 77, 94, 96, 156, 157, 158

Officer No. 1: 88, 97, 174

Oil: 12, 122, 123, 209

Oil Shale: 14, 155

OOLDEA 1:250 000: 48, 181

Ooldea No. 1: 123

Opal : 72

Ordovician: 31, 50, 89, 93, 96, 116, 149, 155, 199, 205, 220

Pacoota Sandstone: 30

Palaeodrainage (Cainozoic): 90, 95, 153, 154, 208

Permian: 1, 4, 5, 7, 32, 73, 84, 93, 108, 150, 152, 154, 186, 187,
199, 190, 191, 192, 193

Petroleum Potential: 12, 33, 34, 52, 53, 71, 81, 82, 83, 89, 96,
122, 123, 146, 155, 163, 169, 172, 191, 194,
204, 217

Petrology: 8, 12, 27, 52, 53, 92, 107, 174, 186, 187, 188, 191,
197, 202, 215, 219, 220

Phosphate, sedimentary: 166

Photogeology: 44, 58, 185

Pidinga: 86

Pindyin Beds: 79, 113

Potash: 73

Precambrian Sediments: 12, 79, 89, 92, 93, 96, 101, 109, 111,
113, 119, 155, 157, 158, 167, 198, 199,
201, 211, 220

Punkerri Beds: 71, 117

Radiometrics: 42

Reconnaissance Geology: 43, 44, 45, 46, 47, 48, 49, 58, 59, 67,
68, 70, 80, 87, 91, 104, 121, 168, 189,
213

Regional Geology: 20, 34, 35, 48, 49, 55, 76, 86, 89, 92, 93, 94,
96, 109, 110, 111, 118, 149, 155, 156, 184,
206, 220

Reid Nos 1, 1A; 124

Rodda Beds: 12, 155, 209, 220

Sand Dunes: see Deserts

Seismic Survey: 13, 23, 24, 25, 26, 61, 125, 126, 128, 129,
130, 131, 132, 133, 136, 142, 143, 144, 147, 160,
161, 162, 165, 170, 210

Serpentine Lakes: 90, 170

Silcrete: 6, 214

Source Rock Studies: 18, 52, 53, 81, 82, 83, 122, 123, 163, 194

Stratigraphy: 20, 34, 76, 79, 86, 89, 92, 93, 94, 96, 101, 109,
11, 111, 112, 113, 114, 115, 116, 117, 118, 119,
149, 155, 156, 184, 192, 193, 206, 215, 218

Stromatolites: 157, 158, 219

Stuart Range Formation: 4, 5, 7, 108, 186, 192, 193

TALLARINGA 1:250 000: 42, 210

Tallaringa Palaeodrainage System: 4, 5, 53, 154, 165

Tallaringa Trough: 4, 5, 7, 42, 53, 62

Tectonics: 31, 35, 92, 93, 120, 134, 151, 183, 184, 205, 216

Tillite: 211

Trace Fossils: 10, 30, 104, 155, 220

Trainor Hill Sandstone: 12, 57, 155, 156, 209, 220

Trilobites: 30, 188, 219

Uranium: 95

Wallira West No. 1: 107, 122, 123, 191, 192

Wanna Beds: see Officer, Basin (W.A.)

Water Wells: 8, 9, 101

Weedina No. 1: 150

Well Velocity Survey: 84, 127

Wilkinson No. 1: 53, 74, 83, 107, 122, 123, 137, 200

Wintinna Trough: 61, 62, 219

Wirrildar Beds: see Observatory Hill Beds

WYOLA 1:250 000: 91

Zeolites: 178

LIST OF PRINCIPAL REFERENCES

Code Number

- 2,4 Allchurch, P.D., Wopfner, H., Harris, W.K. and McGowran, B., 1973. South Australian Department of Mines Cootanoorina No. 1 well. Rep. Invest., geol. Surv. S. Aust., 40.
- 1,2 Benbow, M.C. and Pitt, G.M., 1979. Byilkaoora No. 1 well completion report. S. Aust. Dept. Mines and Energy report 79/115 (unpublished).
- 1,2 Continental Oil Company of Aust. Ltd., 1969. Munyarai No. 1 well, South Australia, stratigraphic drilling project. Well completion report. S. Aust. Dept. Mines and Energy open file Env. 979 (unpublished).
- 3 Finlayson, B., 1979. A geophysical interpretation with depths to magnetic basement - Tallaringa, Giles, Murloocoppie 1:250 000 sheets. S. Aust. Dept. Mines and Energy report 79/90 (unpublished).
- 1,2 Gatehouse, C.G., 1979(a). Well completion report for Murnaroo No. 1. S. Aust. Dept. Mines and Energy report 78/152 (unpublished).
- 1,2 Gatehouse, C.G., 1979(b). Well completion report, Wilkinson No. 1. S. Aust. Dept. Mines and Energy report 79/88 (unpublished).
- 1,2 Grasso, R., 1963. Final well report of Emu No. 1 well, for Exoil Pty. Ltd. S. Aust. Dept. Mines and Energy open file Env. 362 (unpublished).
- 1,2 Henderson, S.W. and Tauer, R.W., 1967. Birksgate No. 1 well, South Australia, stratigraphic drilling project. Well completion report, for Continental Oil Company of Aust. Ltd. S. Aust. Dept. Mines and Energy open file Env. 768 (unpublished).

- 6 Jackson, M.J. and Graaff, W.J.E. van de, in press. Geology of the Officer Basin area in Western Australia. Bull. Bur. Miner. Resour. Geol. Geophys. Aust.
- 1,2 Krieg, G.W., 1969. Geological developments in the eastern Officer Basin of South Australia. Aust. Pet. Explor. Assoc. J., 9: 8-13.
- 2 Krieg, G.W. (Compiler), 1973. EVERARD, South Australia. Explanatory Notes, 1:250 000 geological series. Sheet SG/53-13. Geol. Surv. S. Aust.
- 1, 2, 6 Krieg, G.W., Jackson, M.J. and Graaff, W.J.E. van de, 1976. Officer Basin, in: Leslie, R.B., Evans H.J. and Knight, C.L. (Eds.), Economic Geology of South Australia and Papua New Guinea, 3, Petroleum. Australas. Inst. Min. Metall., Melbourne, pp. 247-253.
- 2 Lydyard, A.J., 1979. A petrographic study of the sediments in seven Officer Basin stratigraphic wells. S. Aust. Dept. Mines and Energy report 79/55 (unpublished).
- 2 Major, R.B., 1971. BIRKSGATE map sheet, Geological Atlas of South Australia, 1:250 000 series. Geol. Surv. S. Aust.
- 2 Major, R.B., 1976. LINDSAY map sheet, Geological Atlas of South Australia, 1:250 000 series. Geol. Surv. S. Aust.
- 1 McKirdy, D.M. and Kantsler, A.J., 1980. Oil geochemistry and potential source rocks of the Officer Basin, South Australia. Aust. Pet. Explor. Assoc. J., 20 (in press).
- 2,5 Meyer, G.M., 1979. Ooldea No. 1 and Reid No. 1 and No. 1A well completion reports. S. Aust. Dept. Mines and Energy report 79/83 (unpublished).

- 3 Milton, B.E., 1979. A summary of geophysical exploration of the western and eastern Officer Basin in South Australia. S. Aust. Dept. Mines and Energy report 79/38 (unpublished).
- 1,2 Pitt, G.M., Benbow, M.C. and Youngs, B.C., 1980. A review of recent geological work in the Officer Basin, South Australia. Aust. Pet. Explor. Assoc. J., 20 (in press).
- 2, 5, 8 Thomson, B.P. (Compiler), 1979. Geological Map of South Australia, 1:1 000 000 scale. Geol. Surv. S. Aust. (in press).
- 2 Thornton, R.C.N., 1978. The geological results of the drilling of Manya No. 1 and Marla No. 1. Mineral Resour. Rev., S. Aust., 143: 47-65.
- 1,2 Townsend, I.J., 1976. Stratigraphic drilling in the Arckaringa Basin, 1969-1971. Rep. Invest. geol. Surv. S. Aust., 45.
- 6 Wells, A.T., Forman, D.J., Ranford, L.C. and Cook, P.J., 1970. Geology of the Amadeus Basin, Central Australia. Bull. Bur. Miner. Resour. Geol. Geophys. Aust., 100.
- 2, 9 White, A.H. and Youngs, B.C., in press. Cambrian alkaline-lacustrine sequence in the northeastern Officer Basin, South Australia. To be published externally; details available from SADME after publication.
- 2 Wopfner, H., 1969. Lithology and distribution of the Observatory Hill Beds, eastern Officer Basin. Trans. R. Soc. S. Aust., 93: 169-183.
- 2, 8 Wopfner, H., 1972. Depositional history and tectonics of South Australian sedimentary basins. Mineral Resour. Rev., S. Aust., 133: 32-50.
- (ALSO IN ECAFE Symposium on Petroleum Resources, Canberra, 1969, Document 1.)

The reader also is referred to the "Atlas of Technical Data", a regularly updated compilation produced by this Department.

BIBLIOGRAPHY

(1)

- 2,4 Allchurch, P.D., Wopfner, H., Harris, W.K. and McGowran, B., 1973. South Australian Department of Mines Cootanoorina No. 1 well. Rep. Invest. geol. Surv. S. Aust., 40.

(2)

- 5 Ashton, S.M., 1975. Progress and final reports, E.L. 188 Wilkinson Lakes area, South Australia, for Western Mining Company Pty. Ltd. S. Aust. Dept. Mines and Energy open file Env. 2576 (unpublished).

(3)

- 4 Balme, B.E., 1967. Birksgate No. 1 Well. Palynological report No. 266. In Henderson and Tauer, 1967.

(4)

- 5 Barclay, C.J., 1975. Final report, EL 175 Wilkinson Lakes area, S.A., for Shell Development (Aust.) Pty. Ltd. S. Aust. Dept. Mines and Energy open file Env. 2613 (unpublished) (See also Env. 2540.)

(5)

- 5 Barclay, C.J. and Kempton, N.H., 1975. Relinquishment report EL 214, Wilkinson Lakes, S.A. for Shell Development (Aust.) Pty. Ltd. S. Aust. Dept. Mines and Energy open file Env. 2663 (unpublished).

(6)

- 5 Barnes, L.C. and Pitt, G.M., 1976. Silcrete, sediments and stratigraphy. S. Aust. Dept. Mines report 76/119 (unpublished).

(7)

- 5 Barnes, L.C., Benbow, M.C., Krieg, G.W., Pitt, G.M., Harris, W.K. and Murray, J.M., 1977. Permian outcrops on the southeastern margin of the Arckaringa Basin. Quart. geol. Notes, geol. Surv. S. Aust., 63: 1-6.

(8)

- 7 Barnes, T.A., 1952. The hydrology and geology of the Giles 4-mile military sheet. S. Aust. Dept. Mines report 34/52 (unpublished).

(9)

- 2,5 Barnes, T.A., 1956. Water boring, Maralinga, geological and hydrological comments. S. Aust. Dept. Mines report 493 (unpublished).

(10)

- 8 Basan, P.D. (ed.), 1978. Trace fossils concepts. SEPM Short Course No. 5.

(11)

- 7 Basedow, H., 1905. Geological report on the country traversed by the South Australian Government North-West Prospecting Expedition, 1903. Trans. R. Soc. S. Aust., 29: 57-102.

(12)

- 1, 2 Benbow, M.C. and Pitt, G.M., 1979. Byilkaora No. 1 well completion report. S. Aust. Dept. Mines and Energy report 79/115 (unpublished).

(13)

- 3 Bowman, H.E. and Harkey, W.J., 1962. Seismic survey report on the Mabel Creek area, S.A. and W.A., for Exoil N.L. S. Aust. Dept. Mines and Energy open file Env. 224, 225. (unpublished).

(14)

- 1,9 Bradley, W.H., 1973. Oil shale formed in desert environment; Green River Formation, Wyoming. Bull. geol. Soc. Am., 84: 1121-1124.

(15)

- 2,5 Broken Hill Proprietary Ltd., 1976. Exploration Licence 216, Ooldea, S.A. Final report. S. Aust. Dept. Mines and Energy open file Env. 2691 (unpublished).

(16)

- 7 Brown, H.Y.L., 1890. Report on journey from Warrina to Musgrave Ranges. Parl. Pap., S. Aust., 45, 1890.

(17)

- 7 Brown, H.Y.L., 1905. Report on geological explorations in the west and northwest of South Australia. Parl. Pap., S. Aust., 71, 1905.

(18)

- 1 Cassou, A.M., 1977. Organic matter study of samples from Munyarai 1 well - Officer Basin. In: S. Aust. Dept. Mines and Energy open file Env. 979 and 2333 (unpublished).

(19)

- 9 Cerling, T.E., 1979. Palaeochemistry of Plio-Pleistocene Lake Turkana, Kenya. Palaeogeog., Palaeoclim., Palaeoecol., 27: 247-285.

(20)

- 2 Coats, R.P., 1963. The geology of the Alberga 4-mile military sheet. Rep. Invest., geol. Surv. S. Aust., 22.

(21)

- 2 Compston, W., 1967. Isotopic age determinations, Birksgate No. 1 bore. In Henderson and Tauer, 1967.

(22)

- 5 Conor, C.H.H. and Young, D.A., 1973. Ferricretes: their occurrence, formation and use in geological interpretation. Quart. geol. Notes, geol. Surv. S. Aust., 47: 1-5.

(23)

- 1,2 Continental Oil Co. of Aust. Pty. Ltd., 1965. Application for geophysical subsidy, Serpentine Lakes reconnaissance seismic project, Officer Basin. S. Aust. Dept. Mines and Energy open file Env. 478 (unpublished).

(24)

- 1,2 Continental Oil Co. of Aust. Pty. Ltd., 1967(a). Application for second extension of subsidy, eastern Officer Basin, seismic and gravity project. S. Aust. Dept. Mines and Energy open file Env. 783 (unpublished).

(25)

- 1,2 Continental Oil Co. of Aust. Pty. Ltd., 1967(b). Application and agreement for subsidy, eastern Officer Basin, seismic and gravity survey, O.E.L. 28, South Australia. S. Aust. Dept. Mines and Energy open file Env. 747 (unpublished).

(26)

- 1,2 Continental Oil of Aust. Pty. Ltd., 1967(c). Progress reports, July-September, 1967, gravity and seismic survey, eastern Officer Basin, O.E.L. 28, South Australia. S. Aust. Dept. Mines and Energy open file Env. 747 (unpublished).

(27)

- 1,2 Continental Oil Company of Aust. Ltd., 1969. Munyarai No. 1 well, South Australia, stratigraphic drilling project. Well completion report. S. Aust. Dept. Mines and Energy open file Env. 979 (unpublished).

(28)

- 4 Cooper, B.J., 1977. Micropalaeontological examination of Observatory Hill Beds. S. Aust. Dept. Mines report 77/40 (unpublished).

(29)

- 4 Cooper, B.J. and Priess, W.V., 1977. Murnaroo No. 1: micropalaeontological investigation. In Gatehouse, 1979(a).

(30)

- 8 Crooks, A.F. and Gatehouse, C.G., 1979. Large tribolite track, Emery Creek, Northern Territory. S. Aust. Dept. Mines and Energy report 79/74 (unpublished).

(31)

- 8 Daily, B., Jago, J.B. and Milnes, A.R., 1973. Large-scale horizontal displacements within Australo-Antarctica in the Ordovician. Nature Physical Science, London, 244 (134): 61-64.

(32)

- 2 Demaison, G., 1969. Stratigraphic drilling in the Arckaringa Sub-basin. Quart. geol. Notes, geol Surv. S. Aust., 31: 4-8.

(33)

- 1 Devine, S.B., 1975. An assessment of the onshore petroleum potential of Central and South Australia. Aust. Pet. Explor. Assoc. J., 15(2): 60-71.

(34)

- 1,2 Devine, S.B. and Youngs, B.C., 1975. Review of the Palaeozoic stratigraphy and petroleum potential of northern South Australia. Aust. Pet. Explor. Assoc. J., 15(1): 45-54.

(35)

- 8 Douth, H.F. and Nicholas, E., 1978. The Phanerozoic sedimentary basins of Australia and their tectonic implications. Tectonophysics, 48: 365-385.

(36)

- 9 Eugster, H.P., 1967. Hydrous sodium silicate from Lake Magadi, Kenya: precursors of bedded chert. Science, 157: 1177-1180.

(37)

- 9 Eugster, H.P., 1969. Inorganic bedded cherts from the Magadi area, Kenya. Contr. Mineral. and Petrol., 22: 1-31.

(38)

- 9 Eugster, H.P. and Hardie, L.A., 1975. Sedimentation in an ancient playa-lake complex: The Wilkins Peak Member of the Green River Formation, Wyoming. Bull. geol. Soc. Am., 86: 319-334.

*(39)

- 9 Eugster, H.P. and Hardie, L.A., 1978. Saline lakes. In: A. Lerman (ed.), Lakes: chemistry, geology and physics. Springer-Verlag, pp. 237-293.

(40)

- 9 Eugster, H.P. and Jones, B.F., 1968. Gels composed of sodium-aluminium silicate, Lake Magadi, Kenya. Science, 161: 160-163.

(41)

1,2,3 Exoil N.L., 1964. Application for subsidy, Giles aeromagnetic survey, O.E.L. 28, S.A. S. Aust. Dept. Mines and Energy open file Env. 399 (unpublished).

(42)

3 Finlayson, B., 1979. A geophysical interpretation with depths to magnetic basement - Tallaringa, Giles, Murloocoppie 1:250 000 sheets. S. Aust. Dept. Mines and Energy report 79/90. (unpublished).

(43)

2 Fitzpatrick, B., 1962. A review of the geology of the margins of the Officer Basin. Report to Continental Oil Co. of Aust. Ltd. and Exoil Pty. Ltd. (unpublished).

(44)

2 Fitzpatrick, B., 1963. Photogeological interpretation, part of E.O.L. 28, South Australia. Report to Continental Oil Co. of Aust. Ltd. and Exoil Pty. Ltd. (unpublished).

(45)

2 Fitzpatrick, B., 1966. Officer Basin summary. Report to Exoil Pty. Ltd. (unpublished).

(46)

2,5 Forbes, B.G., 1968. Officer-Eucla Basin geological reconnaissance. S. Aust. Dept. Mines report 67/97 (unpublished).

(47)

2,5 Forbes, B.G., 1969. Helicopter geological survey in the Officer and Eucla Basins. Preliminary report. S. Aust. Dept. Mines report 68/107 (unpublished).

(48)

2,5 Forbes, B.G., 1970. Geology of the Cook, Ooldea and Barton 1:250 000 sheet areas. S. Aust. Dept. Mines report 70/42 (unpublished).

(49)

2,5 Forbes, B.G., 1972. Geology of the Coompana, Nullarbor and Fowler 1:250 000 areas. S. Aust. Dept. Mines report 72/66. (unpublished).

(50)

2 F.P.C. (A)., 1964. L'Ordovicien d' Indulkana. S. Aust. Dept. Mines and Energy open file Env. 386/1: 106-110 (unpublished).

(51)

2,4 Gatehouse, C.G., 1976. A fossil in the Observatory Hill Beds, South Australia. Quart. geol. Notes, geol. Surv. S. Aust., 60: 5-8.

(52)

1,2 Gatehouse, C.G., 1979(a). Well completion report for Murnaroo No. 1. S. Aust. Dept. Mines and Energy report 78/152 (unpublished).

(53)

1,2 Gatehouse, C.G., 1979(b). Well completion report, Wilkinson No. 1. S. Aust. Dept. Mines report 79/88 (unpublished).

(54)

7 Giles, E., 1899. Australia Twice Traversed: the romance of exploration, being a narrative compiled from the journals of five exploring expeditions into and through central South Australia and Western Australia, from 1872 to 1876. Sampson Low, Worston, Searle and Rivington, London. Two volumes.

(55)

- 2 Glaessner, M.F. and Parkin L.W. (eds.), 1958. The geology of South Australia. J. geol. Soc. Aust., 5.

(56)

- 6 Graaff, W.J.E. van de, 1972. The Wanna Beds - an analogue of recent North Sea sediments. Ann. Rep. 1971, West. Aust. Dept. Mines, 100-102.

(57)

- 1,2 Grasso, R., 1963. Final well report of Emu No. 1, for Exoil Pty. Ltd. S. Aust. Dept. Mines and Energy open file Env. 362 (unpublished).

(58)

- 1,2 Grasso, R., 1965. The photogeology of part of the O.E.L. 28 area, for Exoil N.L. S. Aust. Dept. Mines and Energy open file Env. 453 (unpublished).

(59)

- 1,2 Grasso, R., 1965. Reconnaissance geological survey of part O.E.L. 28 area, for Exoil, N.L. S. Aust. Dept. Mines and Energy open file Env. 1290 (unpublished).

(60)

- 3 Gunson, S. and van der Linden, J., 1956. Regional gravity traverses across the Eucla Basin, 1954-1955. Rec. Bur. Miner. Resources Geol. Geophys. Aust., 1956/145.

(61)

- 3 Hall, J. McG., 1973. Seismic investigations of the Wintinna Trough. S. Aust. Dept. Mines report 73/181 (unpublished).

(62)

- 3 Hall, J. McG. and Townsend, I.J., 1971. Helicopter geological gravity survey of areas marginal to the western Great Artesian Basin. Mineral Resour. Rev., S. Aust., 130: 70-79.

(63)

- 9 Hardie, L.A. and Eugster, H.P., 1971. The depositional environment of marine evaporites: a case for shallow, clastic accumulation. Sedimentology, 16: 187-220.

(64)

- 9 Hardie, L.A., Smoot, J.P. and Eugster, H.P., 1978. Saline lakes and their deposits: a sedimentological approach. Spec. Pubs. int. Assoc. Sediment., 2: 7-41.

(65)

- 4 Harris, W.K., 1967. Continental Oil Birksgate No. 1 Well. S. Aust. Dept. Mines Palynological report 2/67 (unpublished). In Henderson and Tauer, 1967.

(66)

- 2,4 Harris, W.K., 1968. Munyarai No. 1 Well, palynological examination of cores. S. Aust. Dept. Mines report 754. In Continental Oil Co. of Aust. Ltd., 1969.

(67)

- 2 Harrison, J., 1966(a). Geological reconnaissance of the Officer Basin. Report to Continental Oil of Aust. Ltd. (unpublished).

(68)

- 2 Harrison, J., 1966(b). Geology of the eastern Officer Basin. Report to Continental Oil of Aust. Ltd. (unpublished).

(69)

- 9 Hay, R.L., 1968. Chert and its sodium-silicate precursors in sodium-carbonate lakes of east Africa. Contr. Mineral. and Petrol., 17: 255-274.

(70)

- 2 Heath, G.R., 1962. Report on aerial reconnaissance of the southern Officer Basin, 14th-15th June, 1962. S. Aust. Dept. Mines report 682, S.R. 11/5/29 (unpublished).

(71)

- 1,2 Henderson, S.W. and Tauer, R.W., 1967. Birksgate No. 1 well, South Australia, stratigraphic drilling project. Well completion report, for Continental Oil Company of Aust. Ltd. S. Aust. Dept. Mines and Energy open file Env. 768. (unpublished).

(72)

- 2 Hiern, M.N., 1967. Mintabie Opalfield. Min. Rev., Adelaide, 122: 33-36.

(73)

- 8 Holmes, D.A., 1970. South Australia Potash Project SML 329. Final report, for Occidental Minerals Corp. S. Aust. Dept. Mines and Energy open file Env. 1313 (unpublished) (See also Env. 1241).

(74)

- 4 Hos, D.P.C., 1978. Eocene Palynology of SADME Wilkinson No. 1., eastern Officer Basin. In Gatehouse, 1979(b).

(75)

- 2,7 Jack, R.L., 1915. The geology and prospects of the region to the south of the Musgrave Ranges and the geology of the western portion of the Artesian Basin. Bull. geol. Surv. S. Aust., 5.

(76)

- 6 Jackson, M.J. and Graaff, W.J.E. van de, in press. Geology of the Officer Basin area in Western Australia. Bull. Bur. Miner. Resour. Geol. Geophys. Aust.

(77)

- 6 Jackson, M.J., Graaff, W.J.E. van de and Boegli, J.C., 1973. Shallow stratigraphic drilling, Officer Basin, W.A., 1972. Rec. Bur. Miner. Resources. Geol. Geophys. Aust., 1975/49 (unpublished).

(78)

- 2,5 Johns, R.K., 1964. Diamond drilling operations - Roadside (Maralinga) dolomite. Min. Rev., Adelaide, 116: 128-132.

(79)

- 2 Johnson, J.E., 1963. Basal sediments of the north side of the Officer Basin. Quart. geol. Notes, geol. Surv. S. Aust., 7.

(80)

- 2 Johnson, W., 1966. Geological reconnaissance of the Officer Basin. (O.E.L. 28). Report to Continental Oil of Aust. Ltd. (unpublished).

(81)

- 1 Kantsler, A., 1979(a). Officer Basin - Notes on the petrography of the dispersed organic matter. Progress Report 2 of Amdel project: Source rock studies of South Australian sedimentary basins. South Aust. Dept. Mines and Energy open file Env. 3349 (unpublished).

(82)

- 1 Kantsler, A., 1979(b). Source rock analysis and petrography of dispersed organic matter. In Gatehouse, 1979(a).

(83)

- 1 Kantsler, A., 1979(c). Petrography of dispersed organic matter. In Gatehouse, 1979(b).

(84)

- 1,8 Kendall, G.W., 1973. Report on well velocity survey, S.A.G. Cootanoorina No. 1 well. In Allchurch et al., 1973.

(85)

- 5 King, D., 1960. The sand ridge deserts of South Australia and related aeolian landforms of the Quaternary arid cycles. Trans. R. Soc. S. Aust., 83: 99-108.

(86)

- 5 King, D., 1951. Geology of the Pidinga area. Trans. R. Soc. S. Aust., 74: 25-43.

(87)

- 2 Krieg, G.W., 1966. Report on Officer Basin geological reconnaissance. S. Aust. Dept. Mines report 63/61 (unpublished).

(88)

- 2 Krieg, G.W., 1967. Continental stratigraphic well Officer No. 1, well completion report. S. Aust. Dept. Mines report 744 (unpublished).

(89)

- 1,2 Krieg, G.W., 1969. Geological developments in the eastern Officer Basin of South Australia. Aust. Pet. Explor. Assoc. J., 9: 8-13.

(90)

- 5 Krieg, G.W., 1971. Relict drainage in the Serpentine Lakes area. Quart. geol. Notes, geol. Surv. S. Aust., 37: 1-2.

(91)

- 2 Krieg, G., 1971. Comments on Noorina, Wyola, Maurice 1:250 000 geological sheets. S. Aust. Dept. Mines report 71/004 (unpublished).

(92)

- 2 Krieg, G.W., 1972. The Ammaroodinna Inlier. Quart. geol. Notes, geol. Surv. S. Aust., 41: 3-7.

(93)

- 2 Krieg, G.W. (Compiler), 1973. EVERARD, South Australia.
Explanatory Notes, 1:250 000 geological series. Sheet
SG/53-13. Geol. Surv. S. Aust.

(94)

- 2 Krieg, G.W. and Jackson, M.J., 1973. The geology of the
Officer Basin. Rec. Bur. Miner. Resources Geol.
Geophys. Aust., 1973/44 (unpublished).

(95)

- 2,8 Krieg, G.W. and Pitt, G.M., 1978. The potential for
Mesozoic and Cainozoic uranium deposits in South
Australia. S. Aust. Dept. Mines and Energy report
78/3. (unpublished).

(96)

- 1,2,6 Krieg, G.W., Jackson, M.J. and Graaff, W.J.E. van de,
1976. Officer Basin. In: Leslie, R.B., Evans H.J. and
Knight, C.L. (Eds.), Economic Geology of Australia
and Papua New Guinea, 3, Petroleum. Australas. Inst.
Min. Metall., Melbourne, pp. 247-253.

(97)

- 4 Lindsay, J.M., 1967 (a). Continental stratigraphic Officer
No. 1 well. Palaeontological examination and strat-
igraphy. S. Aust. Dept. Mines report 732 (unpublished).

(98)

- 4 Lindsay, J.M., 1967(b). Continental Birksgate stratigraphic
Well No. 1., palaeontological examination and
stratigraphy. S. Aust. Dept. Mines report 733
(unpublished).

(99)

- 4 Lindsay, J.M., 1967(c). Continental Birksgate No. 1 Well,
palaeontological examination and stratigraphy. Progress
report No. 1. S. Aust. Dept. Mines report 735
(unpublished).

(100)

- 4 Lindsay, J.M., 1967(d). Continental Birksgate No. 1. Palaeontological examination and stratigraphy. Final report. In Henderson and Tauer, 1967.

(101)

- 2,4 Ludbrook, N.H., 1961. Subsurface stratigraphy of the Marlinga area, South Australia. Trans. R. Soc. S. Aust., 84: 51-59.

(102)

- 2,4 Ludbrook, N.H., 1965. Outback Oil Co. N.L. Cook No. 1 Well, subsurface stratigraphy. S. Aust. Dept. Mines report. 714 (unpublished).

(103)

- 2,4 Ludbrook, N.H., 1966. Hughes-Denman stratigraphic drilling project of Outback Oil Co. N.L., subsurface stratigraphy and micropalaeontology study. S. Aust. Dept. Mines report 731 (unpublished).

(104)

- 2,4 Ludbrook, N.H., 1966. Rock specimens from the Officer Basin, S.A., west of Longitude 133°30'. S. Aust. Dept. Mines report 62/87 (unpublished).

(105)

- 4 Ludbrook, N.H., 1966. Palaeontological examination of drill section from Emu No. 1 well of Exoil N.L. S. Aust. Dept. Mines report 724 (unpublished).

(106)

- 9 Lundell, L.L. and Surdam, R.C., 1975. Playa-lake deposition: Green River Formation, Piceance Creek Basin, Colorado. Geology, 3: 493-497.

(107)

- 2 Lydyard, A.J., 1979. A petrographic study of the sediments in seven Officer Basin stratigraphic wells. S. Aust. Dept. Mines and Energy report 79/55 (unpublished).

(108)

- 5 MacLean, C.H.J., 1975. Report of investigation for coal in the Arckaringa Basin, for B.P. Minerals (Aust.) Pty. Ltd. S. Aust. Dept. Mines and Energy open file Env. 2454 (unpublished).

(109)

- 2 Major, R.B., 1968. Preliminary notes on the geology of the Birksgate 1:250 000 sheet area. S. Aust. Dept. Mines report 66/122 (unpublished).

(110)

- 2 Major, R.B., 1971. BIRKSGATE map sheet, Geological Atlas of South Australia, 1:250 000 series. Geol. Surv. S. Aust.

(111)

- 2 Major, R.B., 1972. Explanatory notes for the Lindsay 1:250 000 geological map. S. Aust. Dept. Mines report 72/161 (unpublished).

(112)

- 2 Major, R.B., 1973(a). The Wirrildar Beds. Quart. geol. Notes, geol. Surv. S. Aust., 45: 8-11.

(113)

- 2 Major, R.B., 1973(b). The Pindyin Beds. Quart. geol. Notes, geol. Surv. S. Aust., 46: 1-5.

(114)

- 5 Major, R.B., 1973(c). The Mangatitja Limestone. Quart. geol. Notes, geol. Surv. S. Aust., 47: 5-9.

(115)

- 5 Major, R.B., 1973(d). Red sandy soils, North West Province. Quart. geol. Notes, geol. Surv. S. Aust., 48: 4-7.

(116)

- 2 Major, R.B., 1974(a). The Boongar Beds. Quart. geol. Notes, geol. Surv. S. Aust., 50: 2-5.

(117)

- 2 Major, R.B., 1974(b). The Punkerri Beds. Quart. geol. Notes, geol. Surv. S. Aust., 51: 2-5.

(118)

- 2 Major, R.B., 1976. LINDSAY map sheet, Geological Atlas of South Australia, 1: 250 000 series. Geol. Surv. S. Aust.

(119)

- 2 Major, R.B. and Teluk, J.A., 1967. The Kulyong Volcanics. Quart. geol. Notes, geol. Surv. S. Aust., 22: 8-11.

(120)

- 8 Mathur, S.P., 1976. Relation of bouguer anomalies to crustal structure in southwestern and central Australia. BMR J. Aust. Geol. Geophys., 1: 277-286.

(121)

- 2 McKenzie, K.G., 1959. A geological reconnaissance of the Woomera-Maralinga area, for Exoil N.L. S. Aust. Dept. Mines and Energy open file Env. 59 (unpublished).

(122)

- 1 McKirdy, D.M. and Kantsler, A.J., 1980. Oil geochemistry and potential source rocks of the Officer Basin, South Australia. Aust. Pet. Explor. Assoc. J., 20 (in press).

(123)

- 1 McKirdy, D.M. and Kantsler, A.J., 1980. Oil geochemistry and assessment of hydrocarbon-source potential of Cambrian and Devonian rocks, Officer Basin, South Australia. S. Aust. Dept. Mines and Energy report 80/10 (unpublished).

(124)

- 2,5 Meyer, G.M., 1979. Ooldea No. 1 and Reid No. 1 and No. 1A

well completion reports. S. Aust. Dept. Mines and Energy report 79/83 (unpublished).

(125)

- 3 Milton, B.E., 1964. Report on seismic refraction depth probes and profiles: Welbourne Hill to Coober Pedy. S. Aust. Dept. Mines report 59/104 (unpublished).

(126)

- 3 Milton, B.E., 1969. Western Arckaringa Basin - depth to basement from seismic investigations. Quart. geol. Notes, geol. Surv. S. Aust., 32: 7-11.

(127)

- 3 Milton, B.E., 1971. Well velocity survey of Mt. Willoughby No. 1. S. Aust. Dept. Mines report 71/37 (unpublished).

(128)

- 3 Milton, B.E., 1972. Report on seismic operations in western and central Arckaringa Basin, 1969. Mineral Resour. Rev., S. Aust., 132: 65-74.

(129)

- 3 Milton, B.E., 1973. Geophysical exploration of the Arckaringa Basin, 1970. Mineral Resour. Rev., S. Aust., 134: 62-76.

(130)

- 3 Milton, B.E., 1974(a). Seismic experiments in the northern Eucla Basin, South Australia. Quart. geol. Notes, geol. Surv. S. Aust., 51: 5-9.

(131)

- 3 Milton, B.E., 1974(b). Experimental seismic exploration, eastern Eucla Basin, South Australia. Quart. geol. Notes, geol. Surv. S. Aust., 52: 4-9.

(132)

- 3 Milton, B.E., 1975. Reconnaissance seismic exploration, southwest Arckaringa Basin, South Australia, 1974. Quart. geol. Notes, geol. Surv. S. Aust., 53: 3-9.

(133)

- 3 Milton, B.E., 1979. A summary of geophysical exploration of the western and eastern Officer Basin in South Australia. S. Aust. Dept. Mines and Energy report 79/38 (unpublished).

(134)

- 3 Milton, B.E. and Parker, A.J., 1973. An interpretation of geophysical observations on the northern margin of the Eastern Officer Basin. Quart. geol. Notes, geol. Surv. S. Aust., 46: 10-14.

(135)

- 2,3 Milton, B.E. and Thornton, R.C.N., 1970. Discovery of a dense Lower to Middle Palaeozoic dolomite in the northwest Arckaringa Basin. Quart. geol. Surv. S. Aust., 36: 10-15.

(136)

- 3 Moorcroft, E., 1969. Seismic reflection, refraction and gravity survey, Eastern Officer Basin, 1966. Min. Rev., Adelaide, 126: 58-70.

(137)

- 2,4 Muir, M., 1979. Palynological examination of microfossils from the Observatory Hill Beds, Wilkinson No. 1 DDH, Officer Basin, South Australia. In: Gatehouse, 1979(b).

(138)

- 3 Mumme, I.A., 1961. Geophysical survey of the Officer Basin, South Australia. S. Aust. Dept. Mines and Energy SR file 11/8/48 (unpublished). (Published as Trans. R. Soc. S. Aust., 87: 119-122).

(139)

- 3 Mumme, I.A., 1963. Geophysical survey of the Officer Basin, S.A. Trans. R. Soc. S. Aust., 87: 119-122.

(140)

- 7 Murray, W.R., 1904. Fowlers Bay to Rawlinson Ranges and Fowlers Bay to Cambridge Gulf. Parl. Pap. S. Aust., 43, 1904.

(141)

- 1,2 Murumba Oil, N.L., 1970. Eastern Officer Basin, helicopter gravity survey subsidy application. S. Aust. Dept. Mines and Energy open file Env. 1196 (unpublished).

(142)

- 3 Namco-International Inc., 1962(a). Mabel Creek seismic survey, seismic sections, for Exoil N.L. S. Aust. Dept. Mines and Energy open file Env. 224, 225 (unpublished).
(See also Bowman and Harkey, 1962.)

(143)

- 3 Namco-International Inc., 1962(b). Mabel Creek seismic survey, time sections, progress report for Exoil N.L. S. Aust. Dept. Mines and Energy open file Env. 196 (unpublished). (See also Bowman and Harkey, 1962.)

(144)

- 3 Namco-International Inc., 1962(c). Mabel Creek seismic survey shothole location maps for Exoil N.L. S. Aust. Dept. Mines and Energy open file Env. 214 (unpublished).

(145)

- 3 Nettleton, L.L., 1970. Eastern Officer Basin gravity survey, PEL 10 and 11, South Australia, for Murumba Oil N.L. S. Aust. Dept. Mines and Energy open file Env. 1196 (unpublished).

(146)

- 1 New Ventures Team (Shell Development Aust. Pty. Ltd.), 1975(a).
An assessment of the Munyarai prospect PEL 12 (Eastern Officer Basin). S. Aust. Dept. Mines and Energy open file Env. 2509 (unpublished).

(147)

- 3 New Ventures Team (Shell Development Aust. Pty. Ltd.), 1975(b).
Final operations report, Everard seismic survey, Officer Basin. S. Aust. Dept. Mines and Energy open file Env. 2509 (unpublished).

(148)

- 1,2 Outback Oil Co. N.L., 1966. Stratigraphic drilling project, O.E.L. 33, South Australia, well completion reports. S. Aust. Dept. Mines and Energy open file Env. 645 (unpublished).

(149)

- 2 Packham, G.H. and Webby, B.D., 1969. The geology of the Officer Basin in the Everard 1:250 000 map area, for Murumba Oil N.L. S. Aust. Dept. Mines and Energy open file Env. 1147 (unpublished).

(150)

- 8 Papalia, N., 1970. Final report on Weedina No. 1, South Australia, for Pexa Oil N.L. S. Aust. Dept. Mines and Energy open file Env. 1374 (unpublished).

(151)

- 8 Plumb, K.A., 1979. The tectonic evolution of Australia. Earth Sci. Rev., 14: 205-249.

(152)

- 2 Pitt, G.M. (compiler), 1978. MURLOOCOPPIE South Australia. Explanatory Notes, 1:250 000 geological series. Sheet SH/53-2 Geol. Surv. S. Aust. (See also Pitt, G.M., 1976:

Report of Geology, Murloocoppie 1:250 000 area. S.
Aust. Dept. Mines Report 76/64 (unpublished.)

(153)

- 2 Pitt, G.M., in press. Palaeodrainage systems in western South Australia: their detection by LANDSAT imagery, stratigraphic significance and economic potential. In Proceedings of LANDSAT Symposium, Sydney, May, 1979.

(154)

- 5 Pitt, G.M., Benbow, M.C., Barnes, L.C., Harris, W.K. and Lindsay, J.M., 1978. Report on drilling in the Tallaringa Palaeodrainage System, 1976. S. Aust. Dept. Mines report 78/38 (unpublished).

(155)

- 1,2 Pitt, G.M., Benbow, M.C. and Youngs, B.C., 1980. A review of recent geological work in the Officer Basin, South Australia: Aust. Pet. Explor. Assoc. J., 20 (in press).

(156)

- 1,2 Pitt, G.M. and Watts, T.R., 1980. Report on 1979 helicopter geological survey, central Officer Basin, South Australia. S. Aust. Dept. Mines and Energy report in preparation (unpublished).

(157)

- 6 Preiss, W.V., 1975. Proterozoic stromatolites from the Western Australian portion of the Officer Basin and their biostratigraphic significance. S. Aust. Dept. Mines report 75/12 (unpublished).

(158)

- 4,6 Preiss, W.V., 1976. Proterozoic stromatolites from the Nabberu and Officer Basins, Western Australia, and their biostratigraphic significance. Rep. Invest., geol. Surv. S. Aust., 47.

(159)

- 3 Quilty, J.H. and Goodeve, P.E., 1958. Reconnaissance airborne magnetic survey of the Eucla Basin, S.A.
Rec. Bur. Miner. Resources Geol. Geophys. Aust.,
1958/87.

(160)

- 3 Raitt, J.S. and Bowman, H.E., 1967. Eastern Officer Basin seismic and gravity survey, O.E.L. 28, S.A. for Continental Oil Co. of Aust. Pty. Ltd. S. Aust. Dept. Mines and Energy open file Env. 829 (unpublished).

(161)

- 3 Ray-Geophysics, 1966(a). Seismic profiles, Line EO stations, for Continental Oil. Co. of Aust. Pty. Ltd. S. Aust. Dept. Mines and Energy open file Env. 697 (unpublished).

(162)

- 3 Ray-Geophysics Aust., 1966(b). Plans for Officer Basin seismic survey Line EO playback sections, for Continental Oil Co. of Aust. Pty. Ltd. S. Aust. Dept. Mines and Energy open file Env. 692 (unpublished).

(163)

- 1 Reiman, K. and Deilwart, J.E.A.M., 1973. Source rock and carbonization evaluation well Cootanoorina-1, S.A., for Shell Dev. Aust. Pty. Ltd. S. Aust. Dept. Mines and Energy open file Env. 2333 (unpublished).

(164)

- 8 Robert, I.K., 1975. Illite crystallinity, Munyarai-1, Officer Basin, for Shell Dev. Aust. Pty. Ltd. S. Aust. Dept. Mines and Energy open file Env. 2333 (unpublished).

(165)

- 5 Roberts, D.C., 1976. Seismic refraction investigation of the Tallaringa Palaeochannel, August, 1976. S. Aust. Dept. Mines report 76/153 (unpublished).

(166)

- 8 Russ, P.J., 1965. Testing of bores from the Eucla and Officer Basins for sedimentary phosphate. S. Aust. Dept. Mines report 60/99 (unpublished).

(167)

- 2 Scott, A.F. and Speer, G.W., 1969. Mallabie No. 1 well completion report. S. Aust. Dept. Mines and Energy open file Env. 1172 (unpublished).

(168)

- 2 Shiels, O.J., 1960. Report on a geological reconnaissance of the South Australian portion of the Officer Basin for Exoil P.L. S. Aust. Dept. Mines and Energy open file Env. 58 (unpublished).

(169)

- 1 Shiels, O.J., 1961. Report on the petroleum prospects of the Officer Basin, S.A. and W.A., for Exoil N.L. S. Aust. Dept. Mines and Energy open file Env. 57 (unpublished).

(170)

- 3 Shorey, D.J., 1966. Serpentine Lakes reconnaissance seismic survey for Continental Oil Co. of Aust. S. Aust. Dept. Mines and Energy open file Env. 603 (unpublished).

(171)

- 9 Smoot, J.P., 1978. Origin of the carbonate sediments in the Wilkins Peak Member of the lacustrine Green River Formation (Eocene), Wyoming, USA. Spec. Pubs. int. Assoc. Sedim., 2: 109-217.

(172)

- 1,2 Sprigg, R.C., 1963. Geology and petroleum prospects of the Simpson Desert. Trans. R. Soc. S. Aust., 86: 35-65.

(173)

- 3 Steenland, N.C., 1965. Eastern Officer Basin aeromagnetic survey, OEL 28, S.A. for Exoil N.L. S. Aust. Dept. Mines and Energy open file Env. 527 (unpublished).

(174)

- 2 Stock, E.C., 1967. Petrological description of core samples from Officer No. 1 well. In Krieg, 1967.

(175)

- 7 Streich, V., 1893. Geological observations taken on the Sir Thomas Elder Expedition, 1891. Trans. R. Soc. S. Aust., 16: 74-115.

(176)

- 9 Surdam, R.C. and Eugster, H.P., 1976. Mineral reactions in the sedimentary deposits of the Lake Magadi region, Kenya. Bull. geol. Soc. Am., 87: 1739-1752.

(177)

- 9 Surdam, R.C., Eugster, H.P. and Mariner, R.H., 1972. Magadi-type chert in Jurassic and Eocene to Pleistocene rocks, Wyoming. Bull. geol. Soc. Am., 83: 2261-2266.

(178)

- 9 Surdam, R.C. and Parker, R.B., 1972. Authigenic aluminosilicate minerals in the tuffaceous rocks of the Green River Formation, Wyoming. Bull. geol. Soc. Am., 83: 689-700.

(179)

- 9 Surdam, R.C. and Stanley, K.O., 1979. Lacustrine sedimentation during the culminating phase of Eocene Lake Gosiute, Wyoming (Green River Formation) Bull. Geol. Soc. Am., 90: 93-110.

(180)

- 9 Surdam, R.C. and Wolfbauer, C.A., 1975. Green River Formation, Wyoming: a playa lake complex. Bull. geol. Soc. Am., 86: 335-345.

(181)

- 2 Teluk, J.A., 1974. Completion report, Exploration Licence 23, Ooldea area, South Australia, for S. Aust. Dept. Mines and Energy open file Env. 2183 (unpublished).

(182)

- 2,8 Thomson, B.P., 1962. Lead distribution in basal Cambrian sediments, South Australia. Quart. geol. Notes, geol. Surv. S. Aust., 2.

(183)

- 8 Thomson, B.P., 1970. A review of Precambrian and Lower Palaeozoic tectonics of South Australia. Trans. R. Soc. S. Aust., 94: 193-221.

(184)

- 2,5,8 Thomson, B.P. (Compiler), ¹⁹⁸⁰~~1979~~. Geological Map of South Australia, 1:1 000 000 scale. Geol. Surv. S. Aust. (~~in press~~).

(185)

- 2,8 Thomson, B.P. and Hiern, M.N., 1973. Studies in small scale geological mapping, South Australia: Corridor 5, Musgrave Block - Officer Basin. S. Aust. Dept. Mines report 73/41. (unpublished).

(186)

- 2,8 Thornton, R.C.N., 1970. Lambina No. 1 well completion report. S. Aust. Dept. Mines report 70/079 (unpublished).

(187)

- 2,8 Thornton, R.C.N., 1971. Mt. Willoughby No. 1 well completion report. S. Aust. Dept. Mines report 71/37 (unpublished).

(188)

- 2 Thornton, R.C.N., 1978. The geological results of the drilling of Manya No. 1 and Marla No. 1. Mineral Resour. Rev., S. Aust., 143: 47-65.
(See also S. Aust. Dept. Mines report 75/106, unpublished).

(189)

- 1,3 Thouvenin, J.P., 1964. Summary of report on field activities during 1963, for French Petroleum Co. (Aust.) Pty. Ltd. S. Aust. Dept. Mines and Energy open file Env. 386/1,2 (unpublished).

(190)

- 2,8 Townsend, I.J., 1970. Stratigraphic drilling programme, 1969, western Arckaringa Basin. S. Aust. Dept. Mines report 70/40 (unpublished).

(191)

- 2 Townsend, I.J., 1971. Wallira West No. 1 well completion report. S. Aust. Dept. Mines report 71/170 (unpublished).

(192)

- 1,2 Townsend, I.J., 1976. Stratigraphic drilling in the Arckaringa Basin, 1969-1971. Rep. Invest. geol. Surv. S. Aust., 45.

(193)

- 2 Townsend, I.J. and Ludbrook, N.H., 1975. Revisions of Permian and Devonian nomenclature of four formations in and below the Arckaringa Basin. Quart. Geol. Notes, geol. Surv. S. Aust., 54: 2-5.

(194)

- 1,4 Vlierboom, F.W., 1973. Palynology and source rock potential of core samples from the Conoco exploration well Munyarai-1, Officer Basin, S.A., for Shell

Dev. Aust. Pty. Ltd. In: S. Aust. Dept. Mines and Energy open file Env. 2333 (unpublished). (See also Env. 979).

(195)

2,8 Warne, S.B., 1972(a). Bore sample analyses, Officer and Pedirka Basins and some bores in Great Artesian Basin, for Asarco (Aust.) Pty. Ltd. S. Aust. Dept. Mines and Energy open file Env. 1880 (unpublished).

(196)

8 Warne, S.B., 1972(b). Bore sample analyses, Arckaringa Basin, for Asarco (Aust.) Pty. Ltd. S. Aust. Dept. Mines and Energy open file Env. 1880 (unpublished).

(197)

2 Watts, T.R., 1967. Birksgate No. 1 Well, Cores 1 and 2: Petrological report. In Henderson and Tauer, 1967.

(198)

2 Webb, A.W., 1978(a). Geochronology of the Officer Basin. Amdel project 1/1/220, Progress Report No. 1. S. Aust. Dept. Mines and Energy open file Env. 3325 (unpublished).

(199)

2 Webb, A.W., 1978(b). Geochronology of the Officer Basin. Amdel Project 1/1/220, Progress Report No. 2. S. Aust. Dept. Mines and Energy open file Env. 3325 (unpublished).

(200)

2 Webb, A.W., 1978(c). Geochronology of the Officer Basin. Amdel Project 1/1/220, Progress Report No. 3. S. Aust. Dept. Mines and Energy open file Env. 3325 (unpublished).

(201)

- 2 Webb, A.W., 1979(a). Geochronology of the Officer Basin. Amdel Project 1/1/220. Progress Report No. 4. S. Aust. Dept. Mines and Energy open file Env. 3325 (unpublished).

(202)

- 2 Webb, A.W., 1979(b). Geochronology of the Officer Basin. Amdel Project 1/1/220, Progress Report 5. S. Aust. Dept. Mines and Energy open file Env. 3325 (unpublished).

(203)

- 2 Webb, A.W., 1979(c). Geochronology of stratigraphically significant rocks from South Australia. Amdel Project 1/1/126, Progress Report No. 28. S. Aust. Dept. Mines and Energy Env. 1689 (unpublished).

(204)

- 1 Webb, E.A., 1965. Will the Officer and Amadeus Basins both be productive? World Oil, June, 1965: 160-165.

(205)

- 8 Webby, B.D., 1978. History of the Ordovician continental platform shelf margin of Australia. J. geol. Soc. Aust., 25: 41-63.

(206)

- 6 Wells, A.T., Forman, D.J., Ranford, L.C. and Cook, P.J., 1970. Geology of the Amadeus Basin, Central Australia. Bull. Bur. Miner. Resour. Geol. Geophys. Aust., 100.

(207)

- 9 Wheeler, W.H. and Textoris, D.A., 1978. Triassic limestone and chert of playa origin in North Carolina. J. sedim. Petrol., 48: 765-776.

(208)

- 2,5 Whitby, K.J. (Clifford McElroy and Associates Pty. Ltd.), 1976. Geology and coal resources, EL. 213, South

Australia, for C.R.A. Exploration Pty. Ltd. S. Aust.
Dept. Mines and Energy open file Env. 2666 (unpublished).

(209)

- 2 White, A.H. and Youngs, B.C., in press. Cambrian alkali
playa-lacustrine sequence in the northeastern Officer
Basin, South Australia. (To be published externally;
details available from SADME after publication).

(210)

- 2 Williams, A.F., 1970. A geological reconnaissance on
portion of the Tallaringa 1:250 000 sheet. S. Aust.
Dept. Mines report 70/75 (unpublished).

(211)

- 2 Wilson, A.F., 1952. Precambrian tillites east of the
Everard Ranges, northwestern South Australia.
Trans. R. Soc. S. Aust., 75: 160-163.

(212)

- 9 Wolfbauer, C.A. and Surdam, R.C., 1974. Origin of
nonmarine dolomite in Eocene Lake Gosiute,
Green River Basin, Wyoming. Bull. geol. Soc. Am.,
85: 1733-1740.

(213)

- 2 Wopfner, H., 1961. A geological inspection of the northern
and western fringe area of the Great Artesian Basin.
S. Aust. Dept. Mines report 52/8 (unpublished).

(214)

- 5 Wopfner, H., 1967. Some observations on the Cainozoic
land surfaces in the Officer Basin. Quart. geol.
Notes, geol. Surv. S. Aust., 23: 3-8.

(215)

- 2 Wopfner, H., 1969. Lithology and distribution of the
Observatory Hill Beds, eastern Officer Basin.

Trans. R. Soc. S. Aust., 93: 169-183.

(216)

- 2,8 Wopfner, H., 1972. Depositional history and tectonics of South Australian sedimentary basins. Mineral Resour. Rev., S. Aust., 133: 32-50.

(Also in ECAFE Symposium on Petroleum Resources, Canberra, 1969, Document 1).

(217)

- 1 Wopfner, H. and Allchurch, P.D., 1967. Devonian sediments enhanced petroleum potential of Arckargina Sub-basin. Aust. Oil and Gas J., 14(3).

(218)

- 1,2 Youngs, B.C., 1974. A brief study of the Eucla Basin with recommendations for further petroleum exploration. S. Aust. Dept. Mines report 780 (unpublished).

(219)

- 2 Benbow, M.C., 1980. Marla 1A, 1B well completion report. S. Aust. Dept. Mines and Energy report in preparation (unpublished).

(220)

- 2 Benbow, M.C., 1980. Report of mapping, Mt. Johns Range. S. Aust. Dept. Mines and Energy report in preparation (unpublished).

(221)

- 4 Harris, W.K., 1980. Re-examination of Munyarai-1: palynology. S. Aust. Dept. Mines and Energy report in preparation (unpublished).

COMPILATION PLANS

The following compilation plans covering western South Australia are available from the South Australian Department of Mines and Energy. Most 1:1 000 000 maps, Explanatory Notes and stipulated 1:250 000 geological maps are published. Unpublished material is available both as uncoloured paper prints and as "Ozafilm" transparencies.

Geological:

1. Regional geological maps, 1:250 000 scale: Fig. 2.
2. Explanatory Notes for 1:250 000 scale Atlas Series geological maps: Fig. 3.
3. Geological map of South Australia, 1:1 000 000 scale (in four parts; to be published in mid-1980; paper prints available at present).

Geophysical

4. Regional aeromagnetic surveys, composite maps prepared, 1:250 000 scale: Fig. 4.
5. Regional gravity surveys, 1:250 000 scale map compilations: Fig. 5.
6. Seismic shothole location maps, 1:250 000 scale: Fig. 6.
7. Seismic shothole location maps of Arckaringa Basin area, 1:100 000 scale.
8. Total magnetic intensity map of South Australia 1:1 000 000 scale (in four parts, published).
9. Bouger Gravity Anomaly map of South Australia 1:1 000 000 scale (in four parts, published)
10. The reader also is referred to Finlayson (1979), who presents a geophysical interpretation of the TALLARINGA 1:250 000 area, with plans of interpreted magnetic provinces, structural provinces, depths to magnetic basement and radiometric correlation.

Metallic exploration:

11. Metallic Exploration Index Series - each area is covered by a series of six maps (geological, geophysical, drilling, mineral occurrences, uranium and geochemistry) displaying the available open

file information. The status of compilation is reported in the Mineral Industry Quarterly series. Maps compiled at 1:250 000 or 1:500 000 scale:

Fig. 7.

Hydrology:

12. Borehole location maps, 1:250 000 scale (water wells and stratigraphic wells predominantly; company exploration drillholes generally not included):

Fig. 8.

GMP/BCY:NK



G.M. PITT

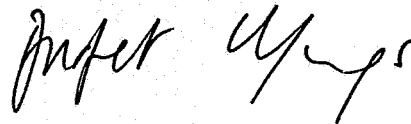

B.C. YOUNGS

Officer Basin Study Group.

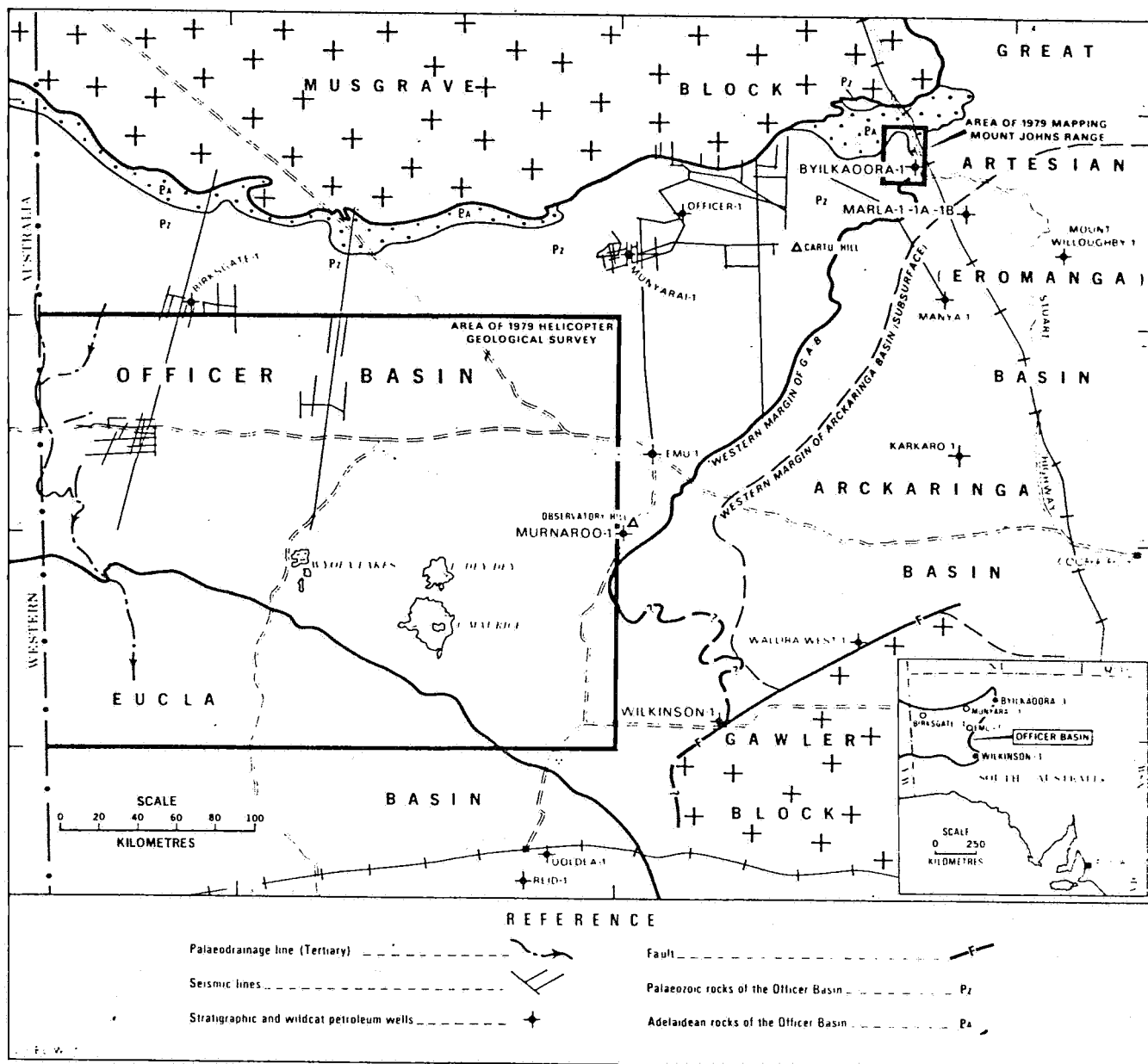

Ref. 79-731

FIG. 1

DEPARTMENT OF MINES AND ENERGY
SOUTH AUSTRALIA

SCALE 1:3,300,000

COMPILED G. Pitt

OFFICER BASIN - SOUTH AUSTRALIA
LOCALITY PLAN

DATE Dec. 6, 1979

DRN E.C. CKD

PLAN NUMBER
S14477

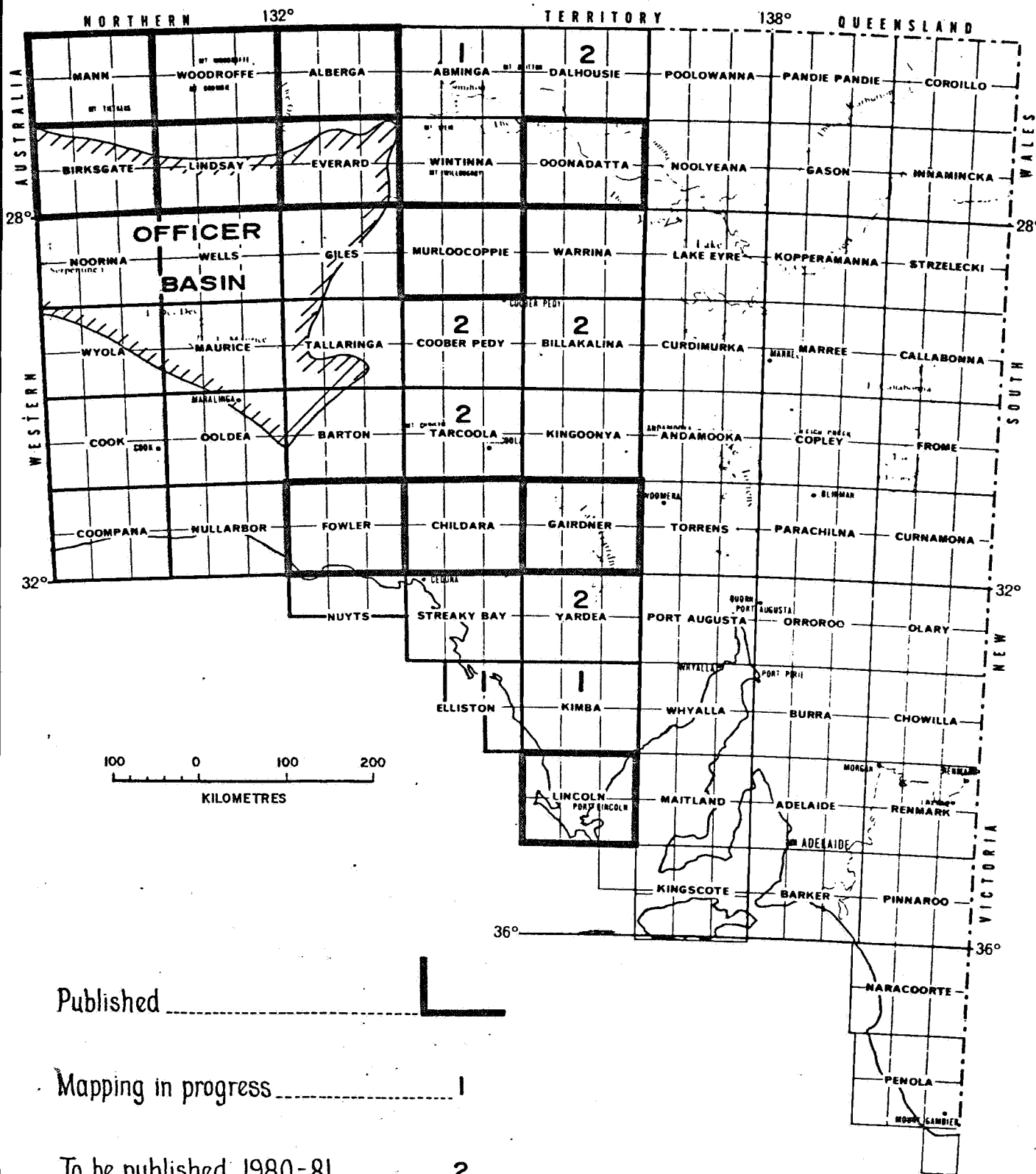

Fig. 2

		DEPARTMENT OF MINES AND ENERGY SOUTH AUSTRALIA		SCALE: 1:6,500,000	
COMPILED: G. Pitt		WESTERN SOUTH AUSTRALIA 1:250,000 REGIONAL GEOLOGICAL MAPS		DATE Dec. 1979	
DRN M.R.	CKD:			PLAN NUMBER	
E.H.				S 14498	

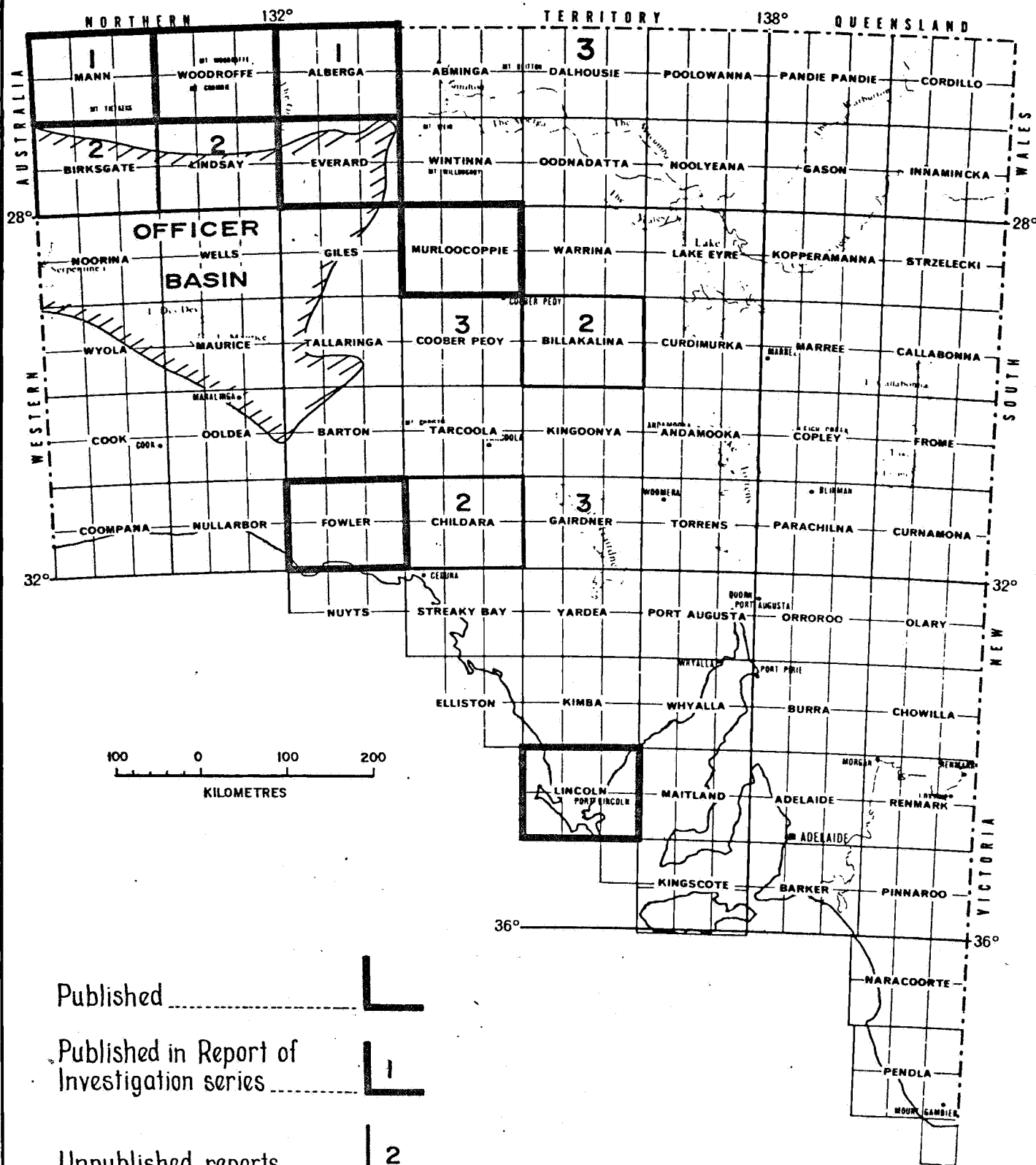

Fig. 3

DEPARTMENT OF MINES AND ENERGY SOUTH AUSTRALIA		SCALE: 1:6,500,000
WESTERN SOUTH AUSTRALIA		DATE Dec. 1979
EXPLANATORY NOTES FOR 1:250,000 GEOLOGICAL MAPS		PLAN NUMBER S 14499
COMPILED: G. Pitt		
DRN: M.R. CKD:		
1746		

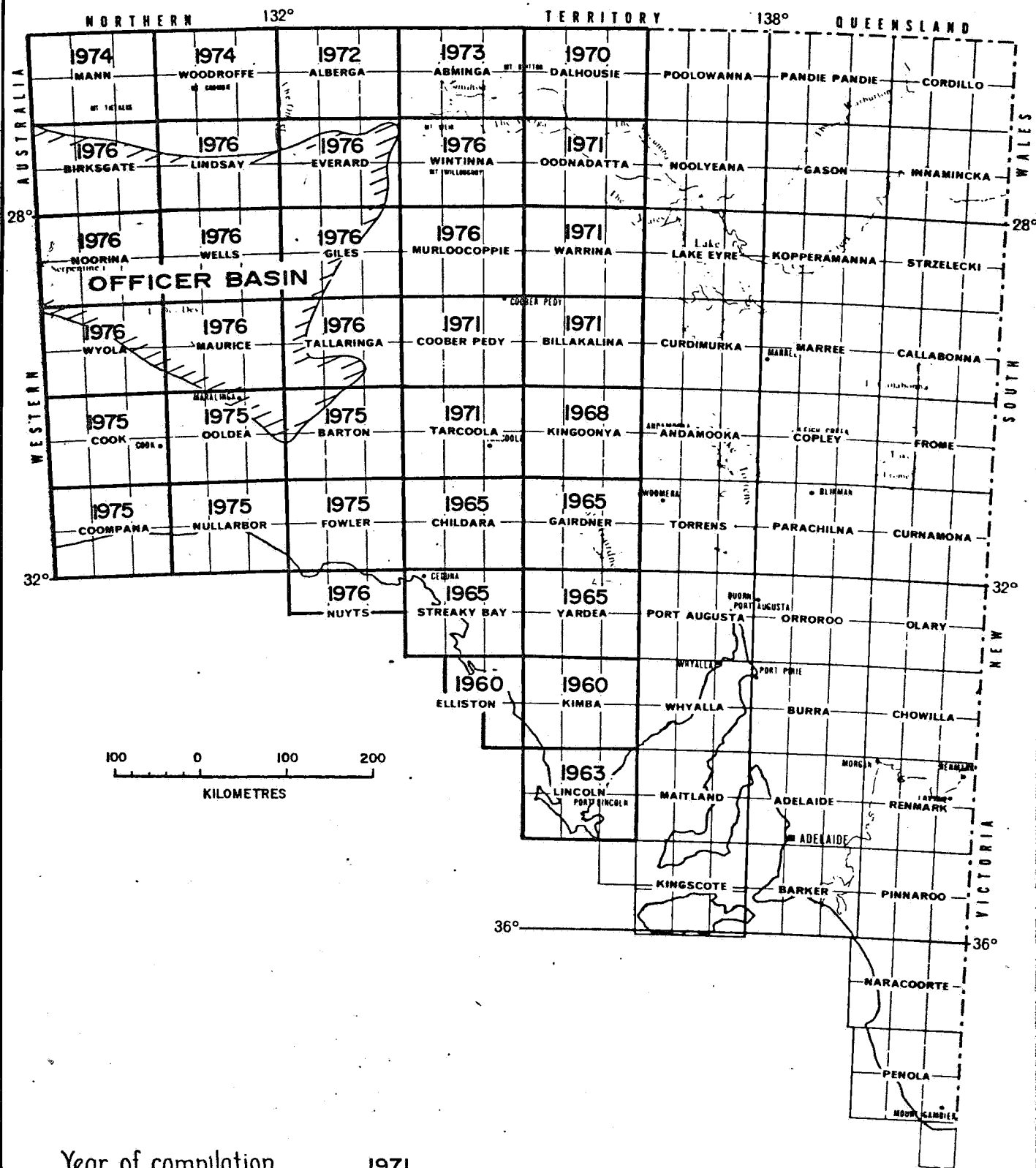

Fig. 4

		DEPARTMENT OF MINES AND ENERGY SOUTH AUSTRALIA		SCALE: 1:6,500,000	
COMPILED: G. Pitt		WESTERN SOUTH AUSTRALIA REGIONAL AEROMAGNETIC SURVEYS 1:250,000 COMPOSITE MAPS PREPARED		DATE Dec. 1979	
DRN: M.R.	CKD:			PLAN NUMBER	
L7K				S 14500	

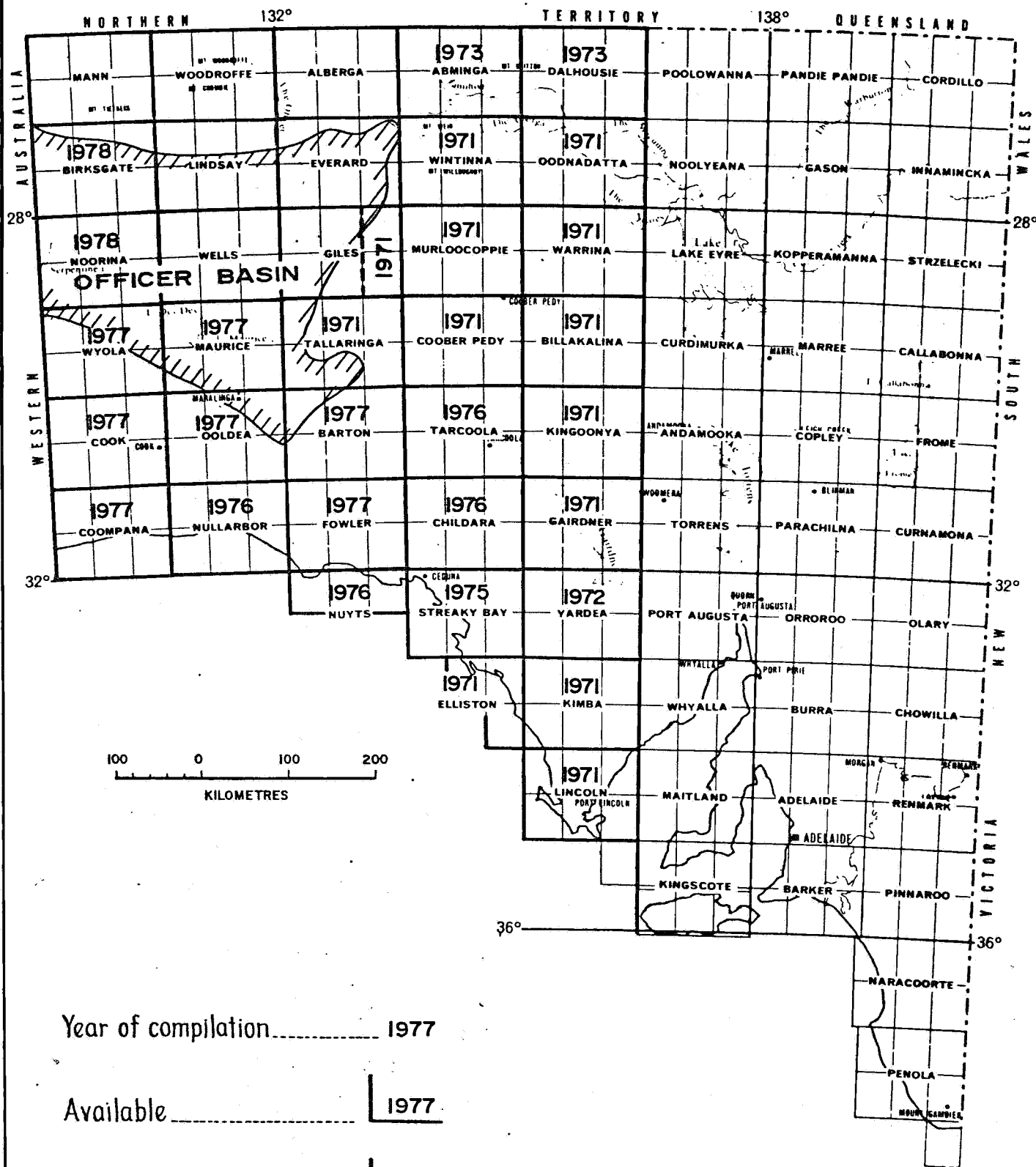

Fig. 5

DEPARTMENT OF MINES AND ENERGY SOUTH AUSTRALIA			SCALE: 1:6,500,000	
COMPILED: G. Pitt			DATE Dec. 1979	
DRN: M.R.	CKD:		PLAN NUMBER	
1746			S 14501	
WESTERN SOUTH AUSTRALIA REGIONAL GRAVITY SURVEYS 1:250 000 MAPS				

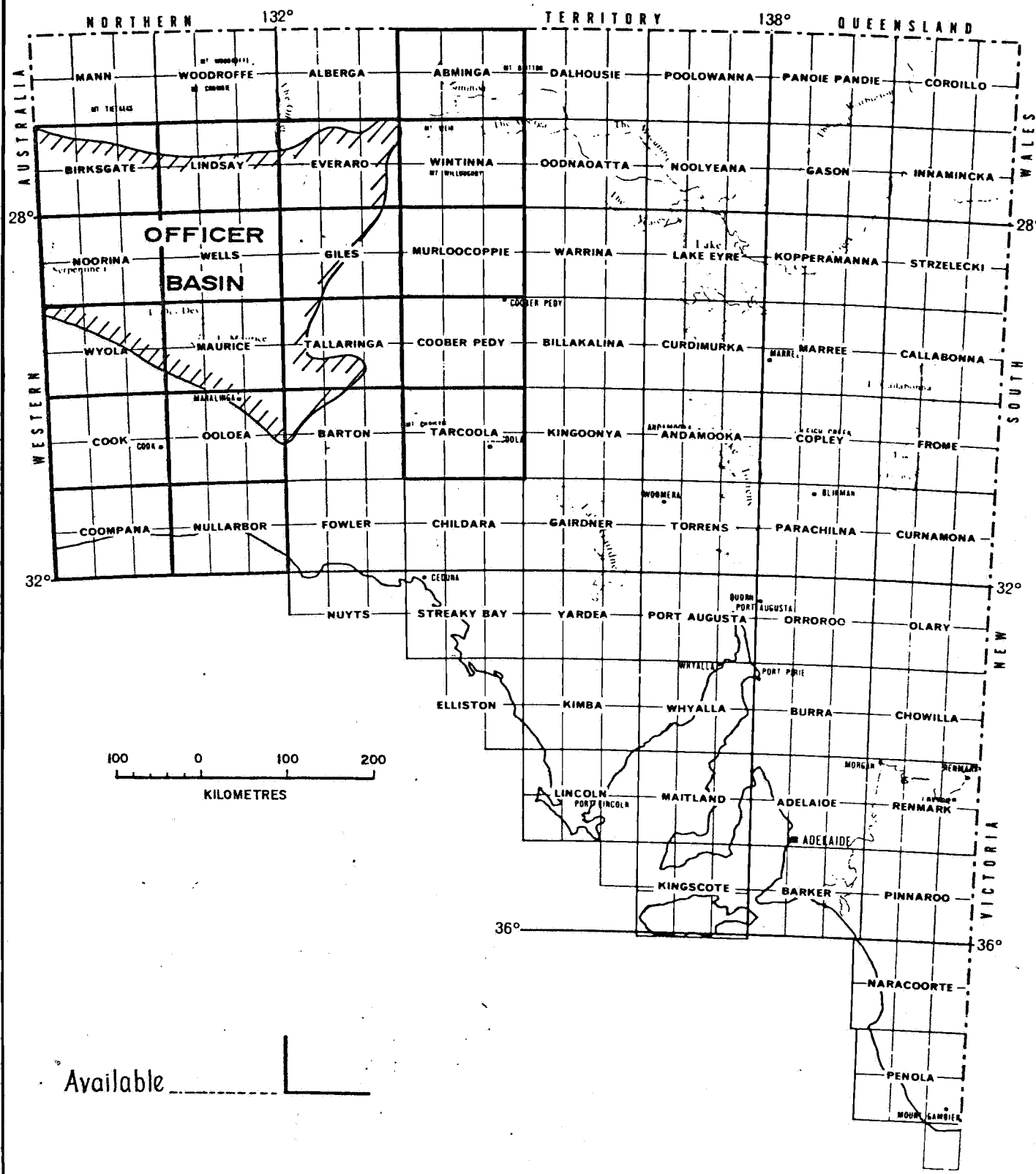

Fig. 6

DEPARTMENT OF MINES AND ENERGY SOUTH AUSTRALIA			SCALE: 1:6,500,000	
COMPILED: G. Pitt			DATE Dec. 1979	
DRN: M.R. CKD:			PLAN NUMBER	
1:250,000 SEISMIC SHOTPOINT LOCATION MAPS			S 14502	

1746

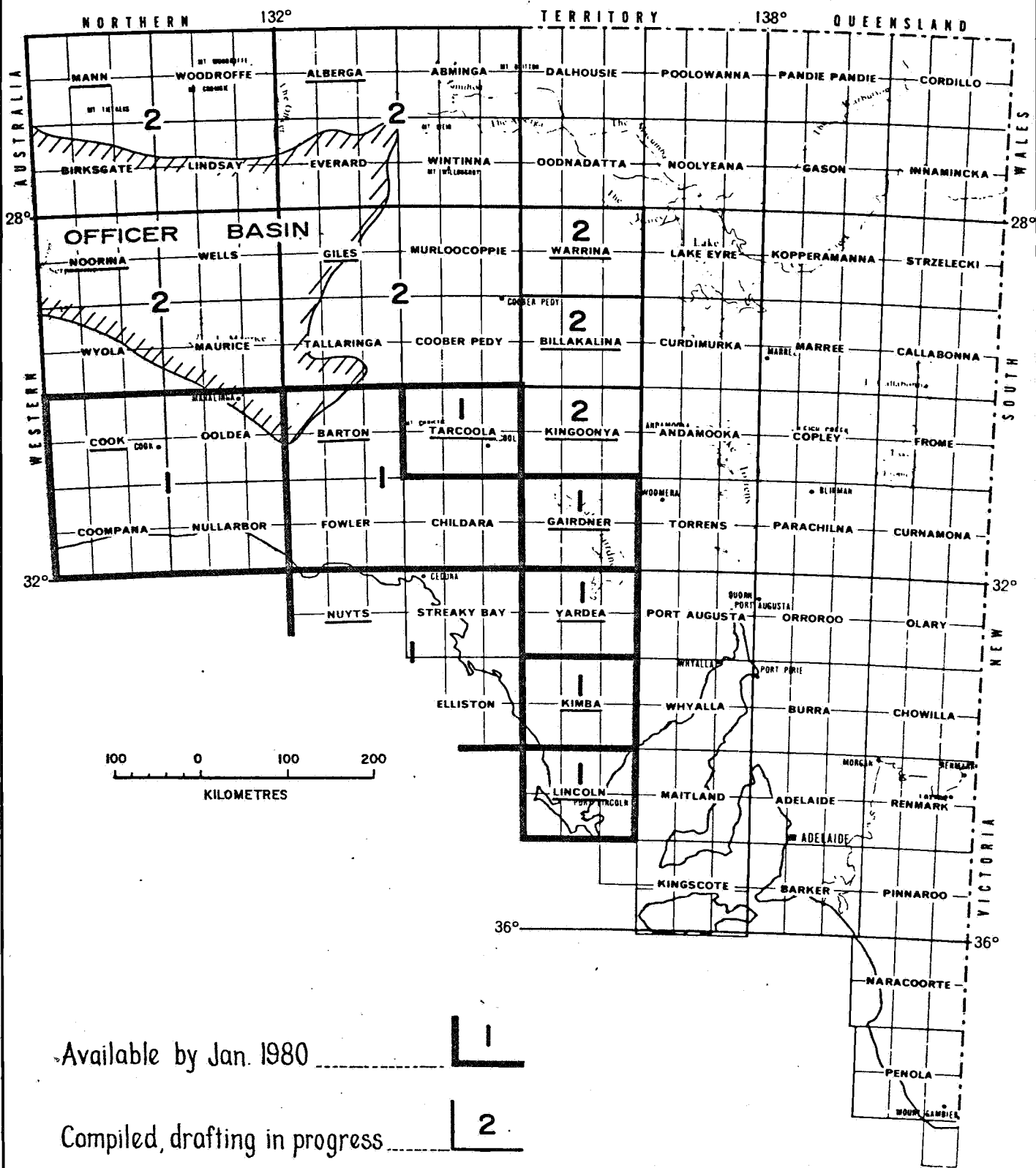

Fig. 7

DEPARTMENT OF MINES AND ENERGY SOUTH AUSTRALIA		SCALE: 1: 6,500,000
COMPILED: G. Pitt	WESTERN SOUTH AUSTRALIA METALLIC EXPLORATION INDEX SERIES	DATE: Dec. 1979
DRN: M R CKD:		PLAN NUMBER
<i>EL</i>		S 14503

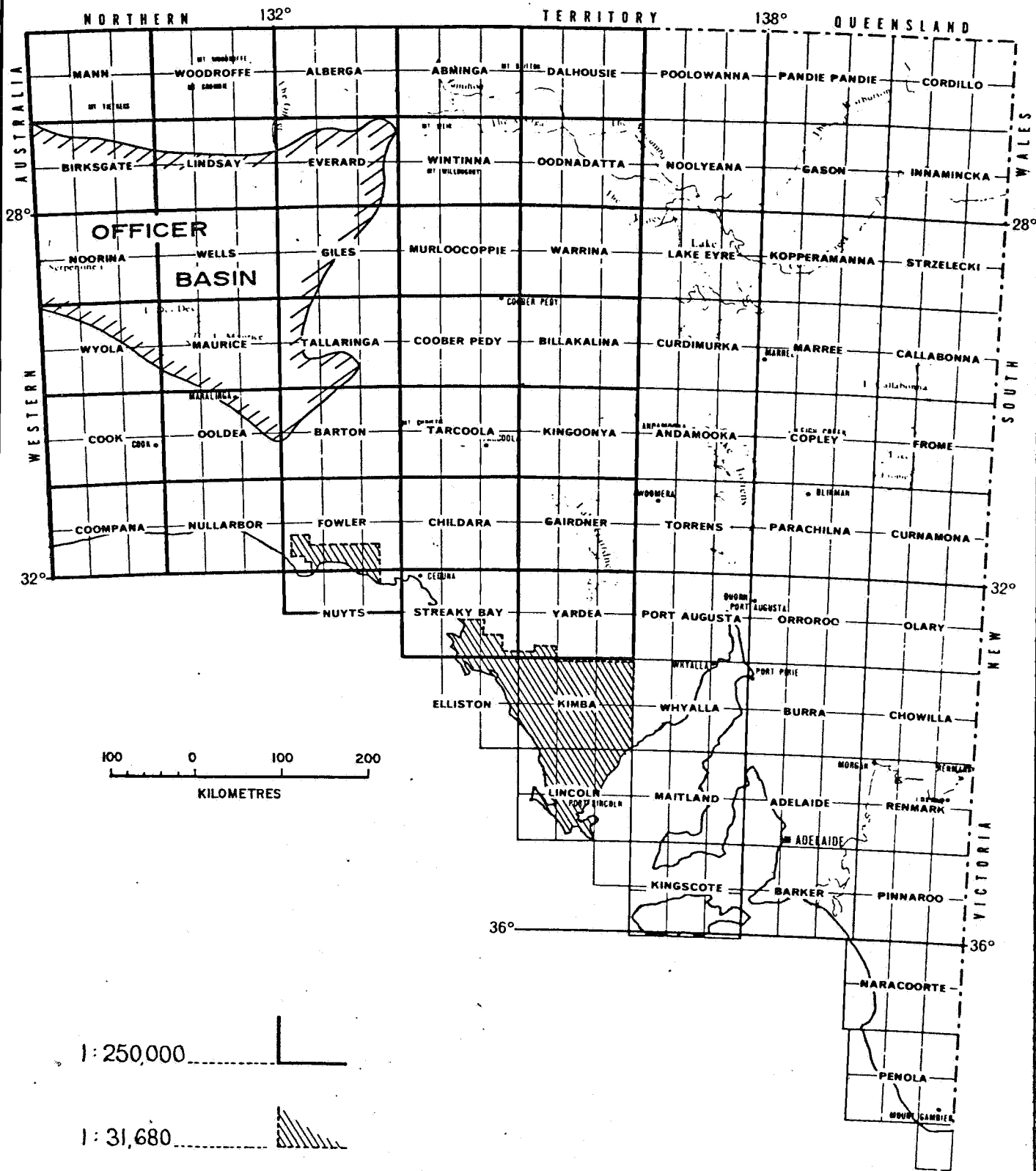

Fig. 8

DEPARTMENT OF MINES AND ENERGY
SOUTH AUSTRALIA

SCALE 1:6,500,000

COMPILED: G. Pitt

WESTERN SOUTH AUSTRALIA

DATE Dec. 1979

DRN: M.R. CKD:

BOREHOLE LOCATION MAPS

PLAN NUMBER

S 14504

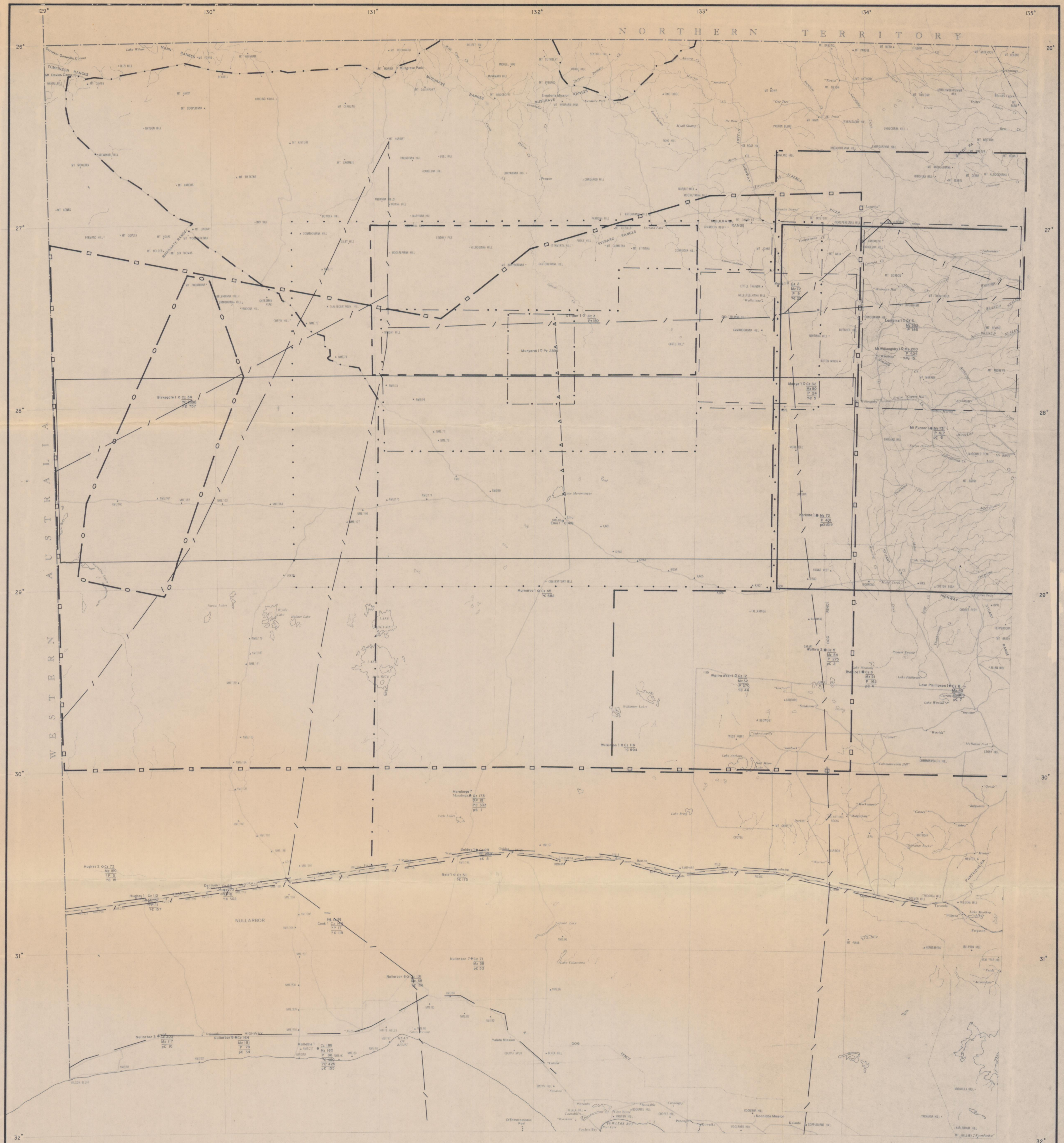

- | | | |
|---|---|--|
| — — — — — Bowman & Harkey 1962 | — — — — — Milton & Thornton 1970 | - / - / - Quilty & Goodeve 1958 (flight lines) |
| — — — — — Gunson & Van der Linden 1956 (land lines) | — — — — — Milton & Parker 1973 | — — — — — Raitt & Bowman 1967 |
| - - - - - Hall 1973 | — Δ — Δ — Moorcroft 1969 (seismic line) | New Ventures Team, Shell 1975 |
| — — — — — Hall & Townsend 1971 | — — — — — Mumme 1963 (land lines) | — ○ — — — Shorey 1966 |
| — — — — — Milton 1973 | Nettleton 1970 | — □ — — — Steenland 1965 |

Scale in kilometres
20 0 20 40 60 80 100

FIG. 9 DEPARTMENT OF MINES AND ENERGY—SOUTH AUSTRALIA			
WESTERN SOUTH AUSTRALIA AREAS COVERED BY GEOPHYSICAL SURVEYS			
COMPILED B.C. Youngs	DRN. E.C.	SCALE 1:1000,000	PLAN NUMBER
DIRECTOR GENERAL	CKD.	DATE Dec. 1979	79-862

See also the following (areas not plotted here) :- Milton 1972, 1974 a, 1974 b, 1975.