

DEPARTMENT OF MINES
SOUTH AUSTRALIA

REPORT ON
TEST BORING OF CLAY DEPOSITS,
SEC. 3240, HD. YATALA,
- A. W. Greening -

by

J. G. Olliver,
Geologist.

NON METALLICS SECTION,
GEOLOGICAL SURVEY

Contents

1. Introduction
2. Geology
3. Geological logs of Boreholes
4. Conclusions

<u>Plan No.</u>	<u>Title</u>	<u>Scale</u>
S3441	Clay Deposit, Section 3240, Hd. Yatala (H.W. Greening)	1 inch = 20 chains 1 inch = 1 mile

Rept. Bk. No. 57/2
G.S. No. 2658
DM 564/

DEPARTMENT OF MINES
SOUTH AUSTRALIA

REPORT ON

TEST BORING OF CLAY DEPOSITS.

SEC. 3240, HD. YATALA.

- A. W. Greening -

1. INTRODUCTION

Following a request from Mr. H. W. Greening, 9 Proline machine auger holes were bored adjacent to an open cut on Section 3240, Hundred Yatala, at Paracombe, 14 miles N.E. of Adelaide, on 11th April, 1963. (See locality plan S3441).

Borehole samples were logged on 27th May, 1963. The property was visited on 28th May, 1963, however the pit had accumulated considerable rainwater and could not be inspected. The boreholes could not be accurately located.

2. GEOLOGY

The property lies within the Archean inlier of schists and gneisses in the vicinity of Paracombe. In this locality, the felspathic gneisses have weathered to a soft, predominately white siliceous clay. Pits expose similar sediments in the adjacent sections (3241 and 5501) to the east.

3. GEOLOGICAL LOGS OF BOREHOLES

Log of borehole No. 1

Depth (feet)		
From	To	
0	2	Dark brown sandy loam with some gravel
2	4	Off-white to brown clay, gritty and sandy
4	14	White to pale pink and brown clay.
14	24	White to pale grey clay.

Hole stopped at 24 feet.

Log of borehole No. 2

Depth (feet)		
From	To	
0	2	Dark brown loam and sandy clay.
2	4	Mottled grey, red-brown and white clay, sandy and gritty
4	8	Pale pink clay
8	28	White to cream and buff clay.

Hole stopped at 28 feet.

Log of Borehole No. 3 - no sample

Log of Borehole No. 4

Depth (feet)		
<u>From</u>	<u>To</u>	
0	8	Brown slightly sandy clay.

Hole stopped at 8 feet.

Log of Borehole No. 5

Depth (feet)		
<u>From</u>	<u>To</u>	
0	2	Loam and brown sandy clay.
2	4	Brown gritty clay over white clay.
4	8	Brown and white banded clay, sandy and gritty.

Hole stopped at 8 feet.

Log of Borehole No. 6

Depth (feet)		
<u>From</u>	<u>To</u>	
0	2	Loam and brown sandy clay
2	6	Mottled white, grey, red and brown sandy clay.
6	10	Brown and white sandy clay, with some 1 inch gravel.
10	14	White, with brown bands, sandy and gritty clay.
14	22	White, pinkish in parts, slightly sandy and gritty clay.

Hole stopped at 22 feet.

Log of Borehole No. 7

Depth (feet)		
<u>From</u>	<u>To</u>	
0	2	Brown loam and sandy clay
2	6	Variegated sandy clay
6	10	Pale buff clay
10	24	White to pale pink clay
24	34	Pale orange clay
34	36	Cream clay.

Hole stopped at 36 feet.

Log of Borehole No. 8

Depth (feet)		
<u>From</u>	<u>To</u>	
0	2	Loam and sandy clay
2	8	White, red and brown mottled sandy clay

<u>From</u>	<u>To</u>	
8	10	White clay, sandy and gritty with red patches.
10	24	White clay with red patches, with sand and grit from 16 to 18 feet.

Hole stopped at 24 feet.

Log of Borehole No. 9

Depth (feet)		
<u>From</u>	<u>To</u>	
0	2	Loam and sandy clay
2	8	Brown clay, sandy to gravelly ($\frac{1}{8}$ inch pebbles)
8	14	White to pale brown clay.

Hole stopped at 14 feet.

4. CONCLUSIONS

Boring has proved white to pale coloured clay, sandy to gravelly in parts, over an area of several acres, covered by a thin veneer of loam.

The depth and extent of the clay are unknown.

Approximately 700 tons of clay have been removed by Brick Improvers Ltd., and samples have been submitted to several brick-making firms, for test-firing.

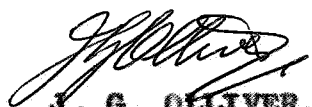
J. G. OLLIVER,
GEOLOGIST,
NON METALLICS SECTION.

JGO:EMD
5.7.63.

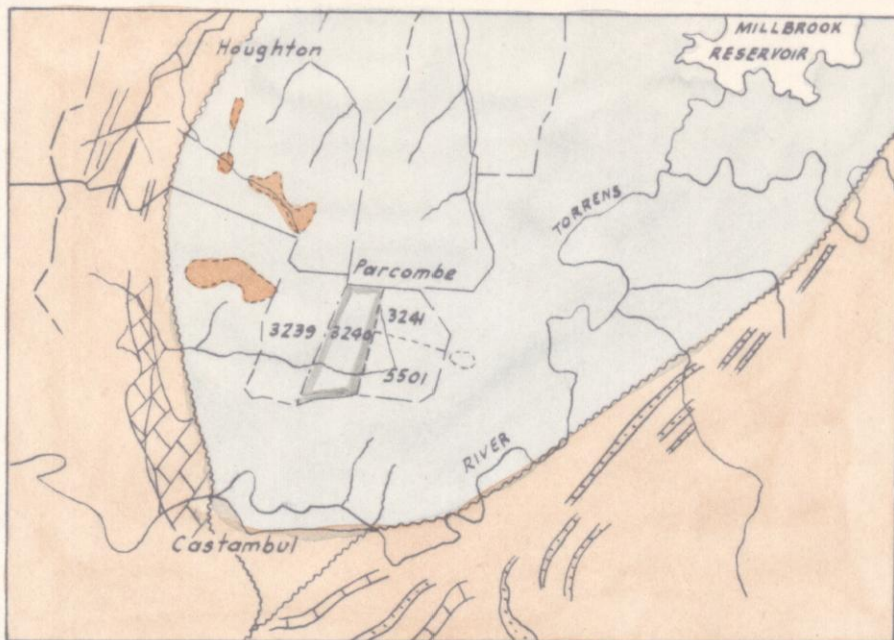

TERTIARY

 Sands and clays

PROTEROZOIC

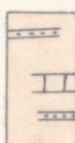
 Torrensian slates and phyllites with interbedded quartzites and dolomites.

ARCHAEAN

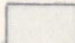
 Schists and gneisses

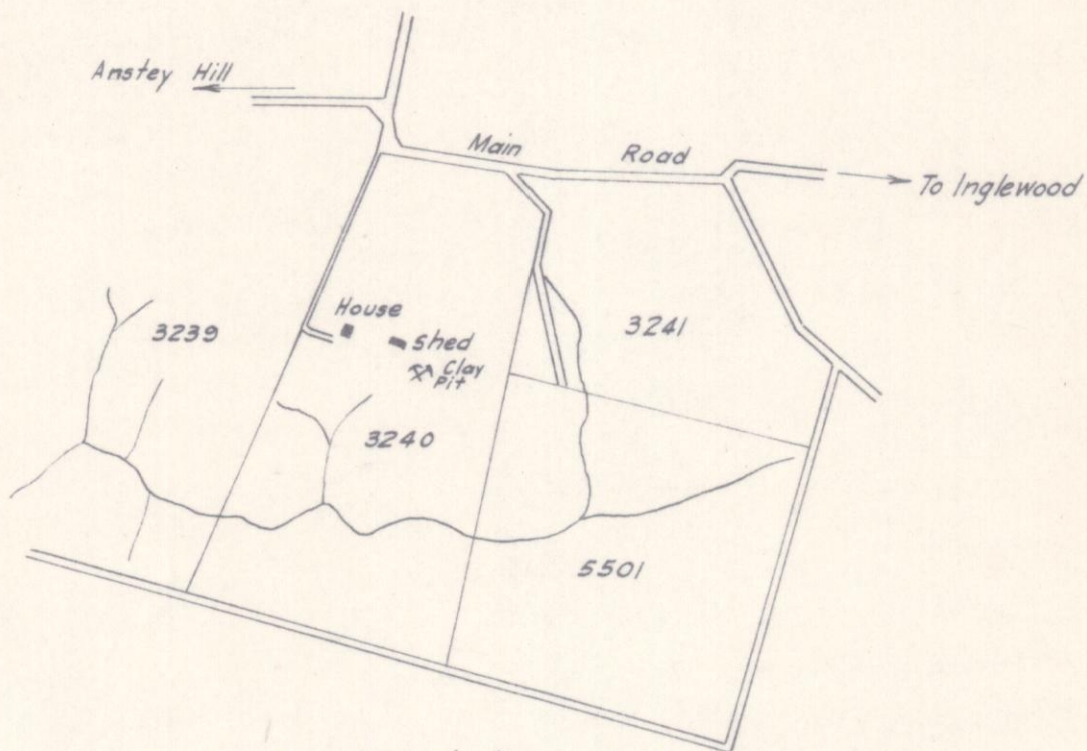

SCALE 20 chs. to inch

To accompany report by J. G. Olliver.

S.A. DEPARTMENT OF MINES

Approved	Passed	Drn. J.G.O.	CLAY DEPOSIT SEC. 3240 HD.YATALA (H.W. GREENING)	D.M.	Scale As shown
		Tcd. A.O.W.		Req.	S 3441
		Ckd.			Ha 5
Director		Exd.			Date 8-7-63